



📍 2 Woodpecker Mews, Chippenham, Wiltshire, SN14 6XX

🔗 £1,475 PCM

A well presented three bedroom detached house with garage and parking situated in the sought after location of Cepen Park North located within a quiet cul-de-sac. Available now, unfurnished, £1350pcm (PETS CONSIDERED FOR AN ADDITIONAL £25PCM).

- TO LET
- WELL PRESENTED
- DETACHED
- THREE BEDROOMS
- POPULAR LOCATION
- GARAGE & PARKING
- ENCLOSED REAR GARDEN
- COUNCIL TAX BAND D
- UNFURNISHED
- AVAILABLE 6TH MAY 2026



🏠 EPC Rating C



A well presented three bedroom detached house with garage and parking situated in the sought after location of Cepen Park North located within a quiet cul-de-sac. Available from 6th May 2026, unfurnished, £1475pcm. (Pets considered)

Accommodation comprises entrance with w/c. A lovely size living room with feature bay window leading through to a contemporary style kitchen/diner that benefits from having an oven, hob and washing machine. There are also sliding doors leading out to the rear garden.

Situated to the first floor are two double bedrooms a single bedroom and a modern bathroom with shower over. The recently re-fitted boiler is situated in the airing cupboard fitted with "Hive" controls.

Externally, there are front and rear gardens, driveway parking and a single garage. There is also a useful shed in the rear garden. The property is within easy reach of local amenities and the town centre whist being within walking distance of two Secondary Schools. Further benefits include, gas fired central heating and double glazing.



Ground Floor

Approx. 36.6sq. metres (393.9sq. feet)

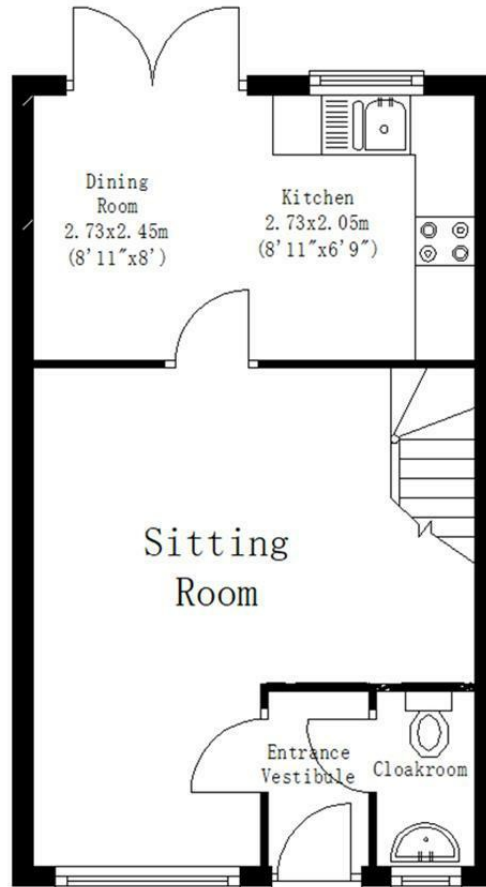

First Floor

Approx. 36.6sq. metres (393.7sq. feet)

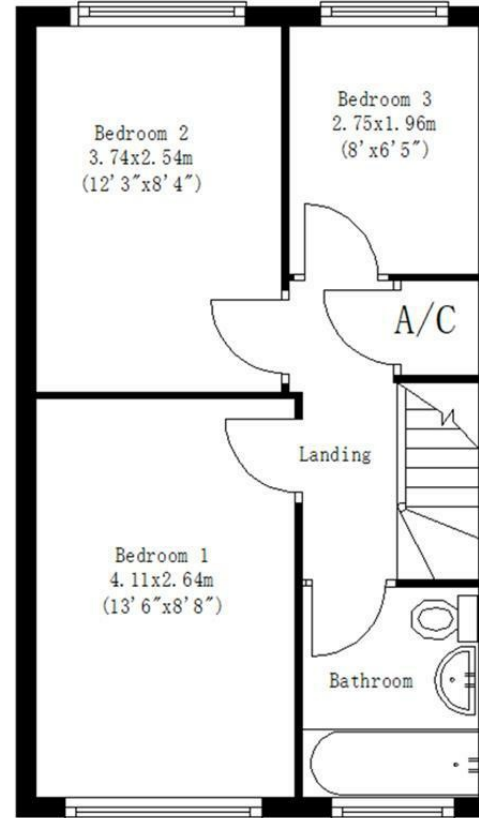

Total area: approx. 73.2sq. metres (787.7sq. feet)

Disclaimer These particulars, whilst believed to be accurate are set out as a general outline only for guidance and do not constitute any part of an offer or contract. Intending purchasers should not rely on them as statements of representation of fact, but must satisfy themselves by inspection or otherwise as to their accuracy. No person in this firm's employment has the authority to make or give any representation or warranty in respect of the property. All measurements and distances are approximate only. Your home is at risk if you do not keep up repayments on a mortgage or other loan secured on it.