



Queen Mary Rise, Sheffield, S2 1JL

Offers In Region Of £100,000

🛏️ 2 🚿 1 🚗 1



Why You'll Love It

Positioned in Queen Mary Rise, a well-regarded residential enclave in Sheffield, this second-floor apartment offers a spacious and stylish living environment. Step inside to discover a modern open-plan lounge and dining area, filled with natural light and perfect for both relaxation and entertaining. The kitchen is thoughtfully designed with ample storage, sleek cabinetry, and integrated appliances, making daily life effortless. The two well-proportioned bedrooms offer comfortable retreats, while the family bathroom is tastefully appointed with contemporary fixtures. With neutral décor and a well-maintained interior, this property is great for investors or first time buyer . Added conveniences include secure intercom entry, double glazing, and allocated parking, providing security and ease for residents. Whether you're expanding an existing portfolio or seeking a first buy-to-let investment, this turnkey opportunity in a popular location is an attractive proposition.

Why We Love It

Sheffield is a city on the rise, and Queen Mary Rise is perfectly placed to benefit from its growing rental demand. Situated close to major transport links, including Sheffield Parkway and the M1, commuting is simple for professionals working in the city or further afield. The area enjoys a mix of local shops, cafés, and green spaces, ensuring a comfortable lifestyle for tenants. With Sheffield Hallam University, Meadowhall Shopping Centre, and key employment hubs nearby.



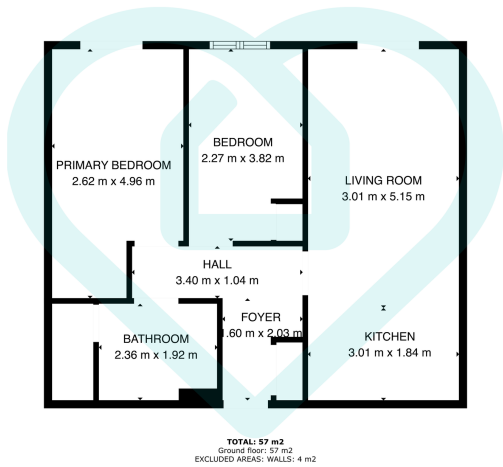

This floor plan is for illustrative purposes only. All measurements and layouts are approximations and do not necessarily capture the precise specifications of the property. No responsibility is taken for any error, omission, or misstatement. We always recommend viewing in person to confirm the exact floor plan of a property. Made with Metropix.



- Great First Home or Investment
- Two Bedroom Apartment
- Good For Commuting To Sheffield and Surrounding Areas
- Secure Development
- Schools Nearby
- Popular Location
- Great Sheffield Location
- Open Plan Living Space
- Close to Local Amenities
- Allocated Parking

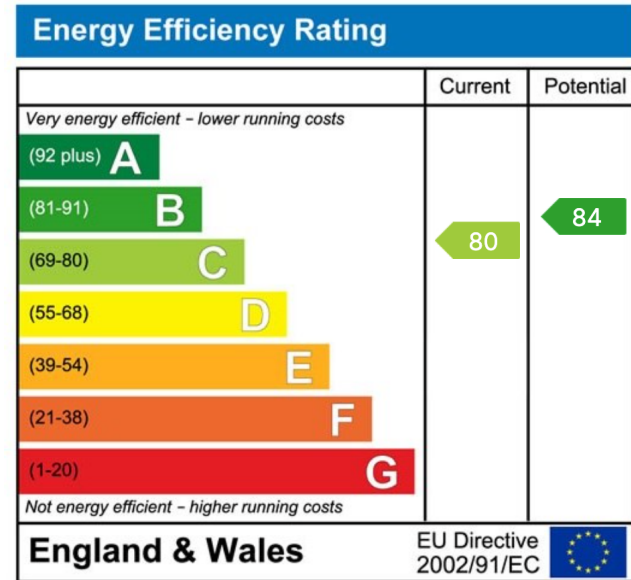

Sales | Lettings | New Homes

VAT Reg Number: 191 3588 84
Company Reg Number: 08610489
Company Reg Address: 67 Middlewood Road, Hillsborough, Sheffield, S6 4GX.

The MorfittSmith Building
67 Middlewood Road
Hillsborough
Sheffield
S6 4GX

Get in touch - arrange an appointment



0114 232 1764
sales@morfittsmith.co.uk
lettings@morfittsmith.co.uk
newhomes@morfittsmith.co.uk
www.morfittsmith.co.uk



@MorfittSmith
@MorfittSmith
MorfittSmith
Estate & Letting Agent