



CALDECOTT

PROPERTY SALES & LETTINGS

Wheatfield Road, Bilton

Guide Price £375,000

 3  1  1



- Extended
- Semi - Detached
- Large Rear Garden
- Modernised Throughout
- Spacious and Stylish Living Areas
- 3 Bedrooms
- Spacious Living
- Sun Room
- UPVC Double Glazing
- Plenty of Storage Areas



Caldecott Property are delighted to present this beautifully modernised and extended three-bedroom semi-detached home, situated in the sought-after area of Bilton. Tastefully updated throughout, the property offers stylish, modern living with generous space ideal for families or professionals. The entrance hall leads to a contemporary kitchen with ample storage. An open-plan layout flows into a bright sunroom and cosy snug, perfect for relaxing or entertaining with views over the expansive rear garden. The living and dining areas are thoughtfully arranged to maximise light and space. Downstairs also features a WC. Upstairs offers three well-sized bedrooms, a modern family bathroom, and useful storage. Outside, enjoy a large, well-maintained garden and off-street parking / driveway. Close to popular schools, amenities, and transport links, this home blends convenience with comfort.

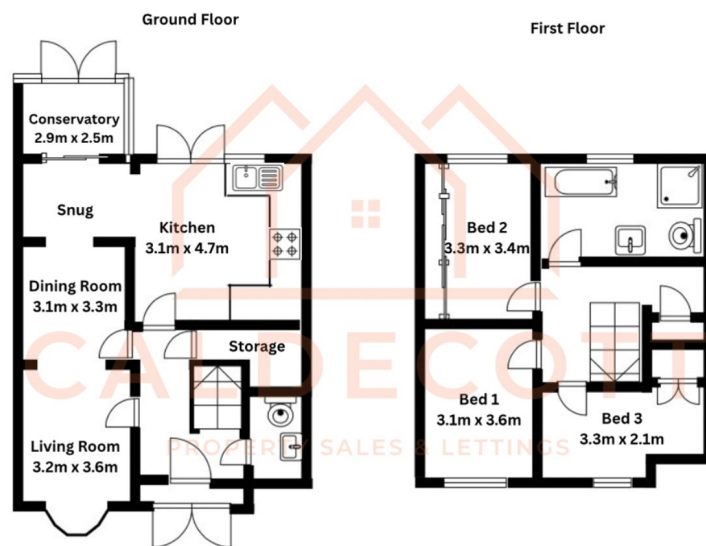

For illustrative purposes only.
Measurements are approximate and floorplan should
be used as a guide.

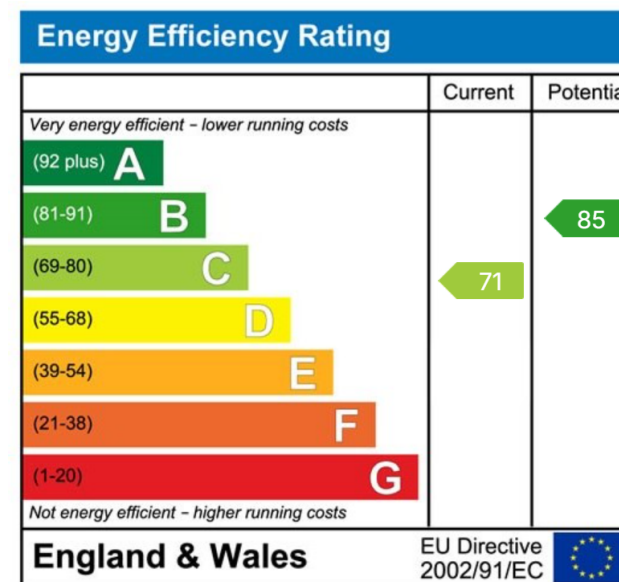

Phone Number:

01788 221994

Email:

Hello@caldecottproperty.co.uk

Website:

www.caldecottproperty.co.uk