



**POOLE  
TOWNSEND**

# Bardsea Close, Dalton-In-furness, LA15 8NW

£199,950

🛏️ 2 🪑 1 🚗 1



- Semi Detached Bungalow
- Popular Residential Area
- Spacious Lounge
- Modern Fitted Kitchen
- Two Bedrooms
- Modern Wetroom
- Front And Rear Gardens
- Detached Garage
- GCH / DG
- NO CHAIN \*\*



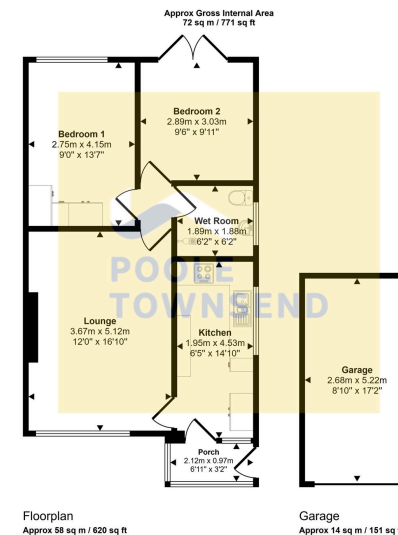

This floorplan is only for illustrative purposes and is not to scale. Measurements of rooms, doors, windows, and any items are approximate and no responsibility is taken for any error, omission or mis-statement. Icons of items such as bathroom suites are representations only and may not look like the real items. Made with Made Snaggy 360.

**PRICE REDUCTION \*\*\*** This semi-detached bungalow is located in a popular part of Dalton, an area considered to be desirable to couples, first-time buyers and families. This property would suit a range of buyers including those looking for a traditional bungalow or maybe a buyer that can see the potential this property holds to extend into the loft as many of the neighbouring homeowners have done. The accommodation includes a spacious lounge that overlooks the front garden, a modern fitted kitchen, two bedrooms and a modern wet room. The property has easier to manage gardens to the front and to the rear where there is also a detached garage with remotely operated door. The property also features a gas-fired central heating system and UPVC framed double glazing and a part boarded loft with ladder access. No upper chain.

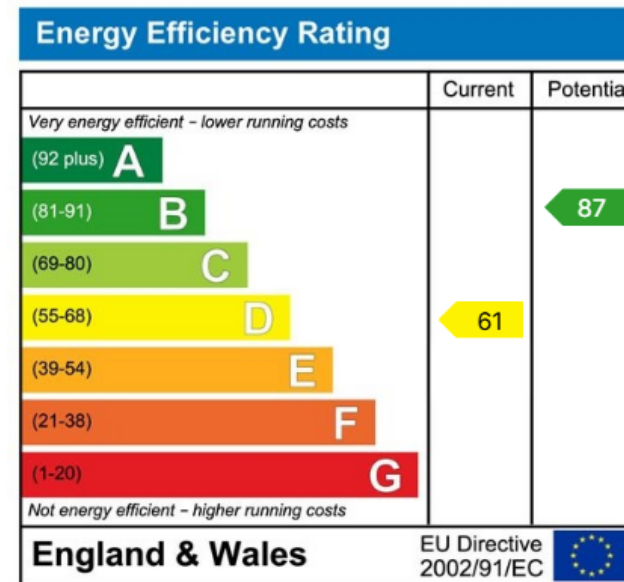

Visit us at  
[www.pooletownsend.co.uk](http://www.pooletownsend.co.uk)  
[enquiries@pooletownsend.co.uk](mailto:enquiries@pooletownsend.co.uk)

We are open  
 Monday – Friday 9.00 – 5.00  
 Saturday 9.00 – 1.00

Barrow 01229 811811  
 Ulverston 01229 588111  
 Grange 015395 33316  
 Kendal 01539 734455  
 Milnthorpe 015395 62044