



Flat 49, Crossways Windsor Road, Slough, SL1 2NE
£325,000

 **HORLER**

Flat 49, Crossways Windsor Road, Slough, SL1 2NE

Nestled on Windsor Road in Slough, this beautifully presented two-bedroom, two-bathroom apartment is a remarkable find in a prestigious development by Bellway Homes. The property features a spacious open-plan kitchen and living area, perfect for modern living and entertaining. The generously sized balcony offers stunning views of Windsor and the surrounding areas, providing a serene outdoor space to relax and unwind.



Both bedrooms are well-proportioned, with the principal bedroom benefiting from an ensuite bathroom, ensuring comfort and privacy. The apartment is designed with contemporary finishes and a thoughtful layout, making it an ideal choice for professionals, couples, or small families.

Additionally, the property includes gated and allocated parking for one vehicle, adding to the convenience of urban living. Local amenities are just a stone's throw away, ensuring that you have everything you need within easy reach. The apartment is also within walking distance to local transport links, including the Elizabeth Line, making commuting a breeze. Furthermore, it falls within the catchment area for some of the best schools in the region, making it an excellent choice for families.

This apartment combines modern living with a prime location, making it a must-see for anyone looking to enjoy the best of Slough and its surroundings. Don't miss the opportunity to make this stunning property your new home.

General Information:

Tenure: Leasehold

Lease Length Remaining: Approx. 119 years

Current Service Charge: Approx. £2,550 per year

Ground Rent: Approx. £295.00 per year

Legal Note:

Although these particulars are thought to be materially correct, their accuracy cannot be guaranteed and they do not form part of any contract.





Crossways SL1

Approximate Gross Internal Floor Area = 66.7 sq m / 719 sq ft

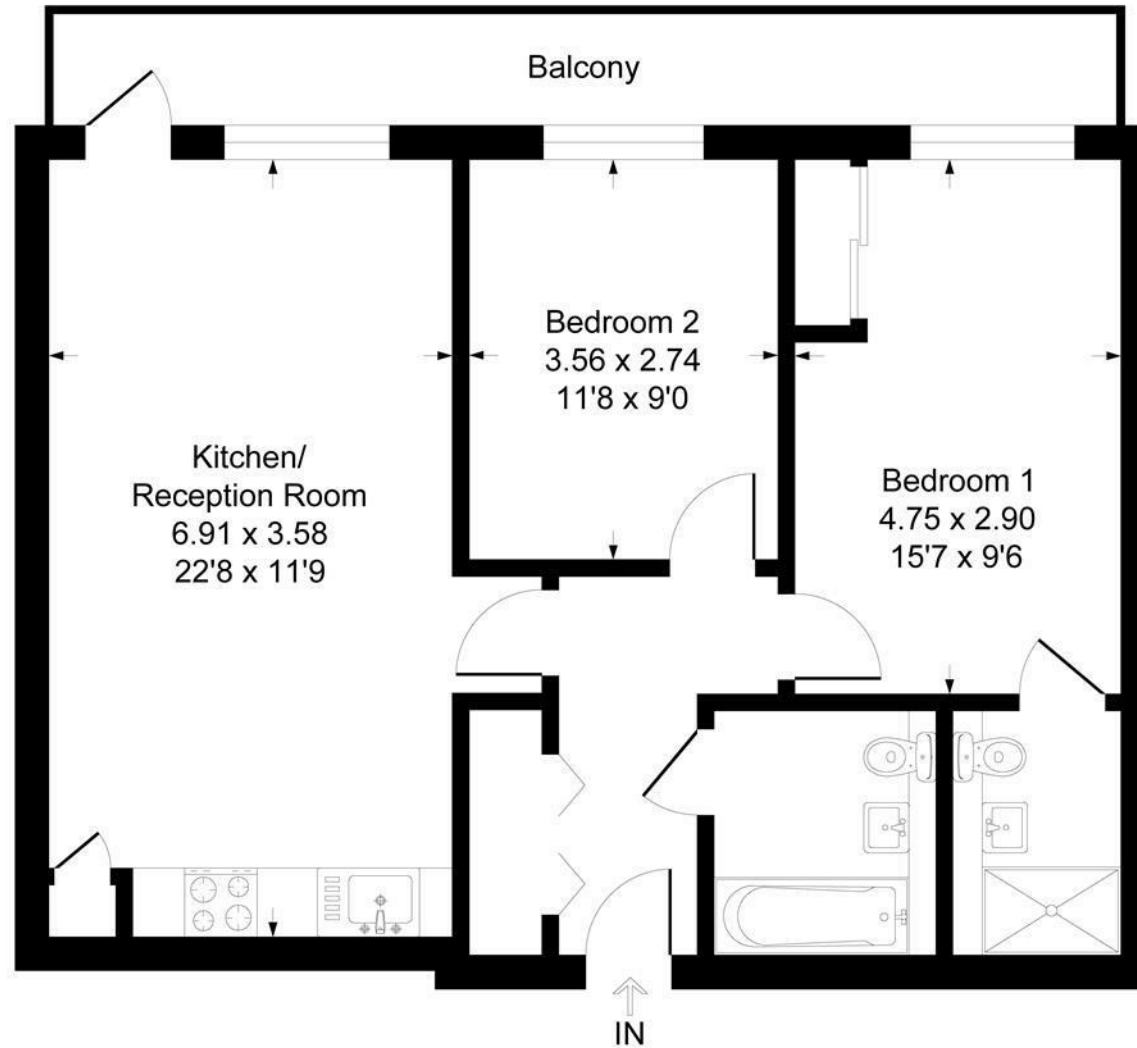

Fifth Floor

Illustration for identification purposes only, measurements are approximate, not to scale.
Produced By Esjay Property Marketing