



DANIEL GREEN

exp[®] UK

@ daniel.green@exp.uk.com

🌐 danielgreen.exp.uk.com

☎ 020 3930 3550 / 07541 999 544

The Foundry, Dacourm Way, Hemel Hempstead, HP1
£350,000

🛏️ 2 🚿 2 🚗 1



- ***PLEASE QUOTE REFERENCE - DG1277***
- Gated Development With Video Entry System
- Spacious Open Plan Living Accommodation & Modern Kitchen
- Allocated Parking & Large Terrace
- Work Hub, Outdoor Table Tennis, BBQ Area & Secure Cycle Store
- Two Bedroom, Two Bathroom Top Floor Apartment
- Beautifully Presented Throughout & Immaculate Condition
- Sought After Location On The Banks Of The River Gade
- 0.3 Miles From The Centre Of Marlowes Shopping Centre



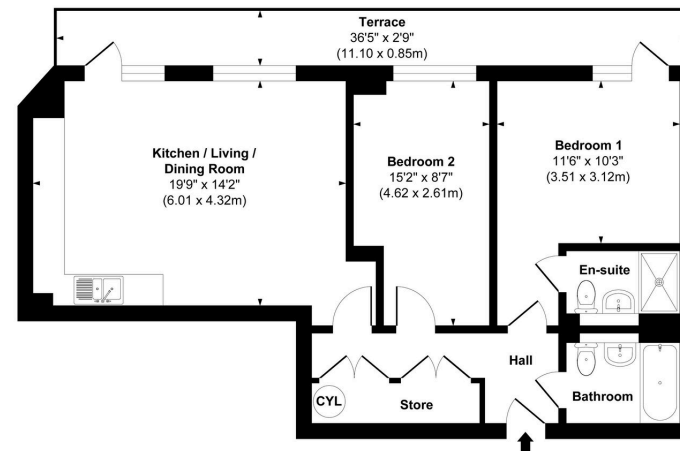

Approx. Gross Internal Floor Area 746 sq. ft / 69.30 sq. m.
 This floorplan is intended for illustrative purposes only and should be used as a general guide. All measurements are approximate and not to scale.
 Exact dimensions should be independently verified.

Set along the peaceful banks of the River Gade in ever-popular Dacorum Way, Hemel Hempstead, this stunning two-bedroom, two bathroom top floor apartment with allocated parking & 0.4 miles of the centre of Marlowes Shopping Centre.

