



Glebe Cottage Lydeard St. Lawrence, Taunton TA4 3SB

£450,000

robert
cooney



A well presented double fronted 3 bedrooomed Victorian detached cottage located in the popular village of Lydeard St. Lawrence at the foot of the Quantock Hills with good sized enclosed established garden to rear, Workshop / Store and off road parking.





Features

- Entrance Hall
- Living Room with inglenook fireplace, woodburner and French doors to garden
- Dining Room with original fireplace
- Kitchen / Dining Room with French doors to garden
- Utility Room with door to garden
- Master Bedroom
- 2 further Bedrooms
- Family Bathroom
- Good sized enclosed established garden to rear with greenhouse
- Workshop / Store with off-road parking
- Oil fired central heating
- Council tax band F
- What3words:
///lads.districts.voted



Glebe Cottage, Lydeard St. Lawrence, Taunton, TA4 3SB

Approximate Area = 1539 sq ft / 142.9 sq m

Garage = 281 sq ft / 26.1 sq m

Total = 1820 sq ft / 169 sq m

For identification only - Not to scale

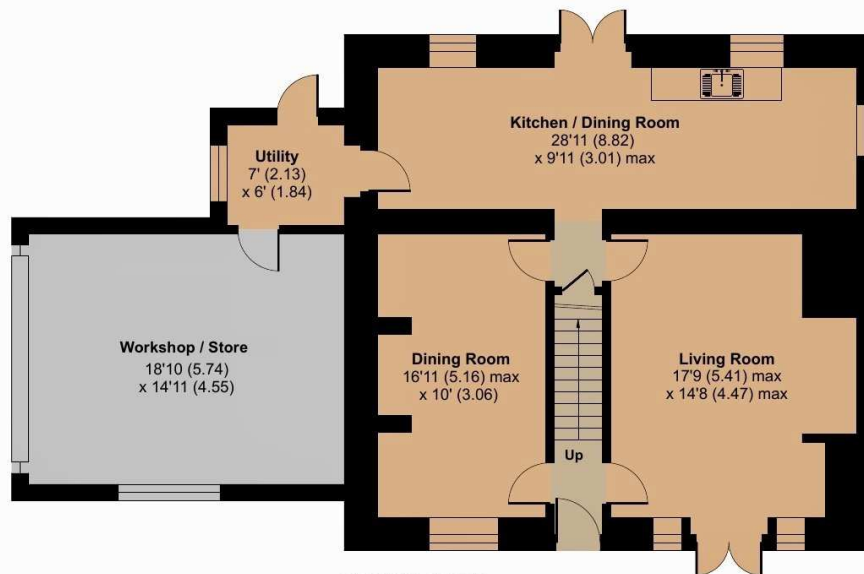

GROUND FLOOR

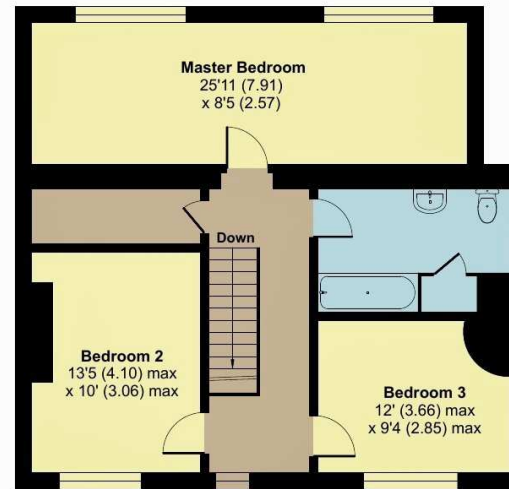

FIRST FLOOR



Viewing strictly through the selling agents:

Robert Cooney

Corporation Street, Taunton,
Somerset TA1 4AW

Telephone 01823 230 230

taunton@robertcooney.co.uk

www.robertcooney.co.uk



Floor plan produced in accordance with RICS Property Measurement 2nd Edition, Incorporating International Property Measurement Standards (IPMS2 Residential). © nichecom 2026. Produced for Robert Cooney. REF: 1469495



For clarification, we wish to inform prospective purchasers that: these particulars are set out as a general outline only for the guidance of intended purchasers, and do not constitute, nor constitute part of, an offer or contract; all descriptions, dimensions, references to condition and necessary permission for use and occupation, and other details, are given without responsibility and any intending purchasers should not rely on them as statements or representation of fact, but must satisfy themselves by inspection or otherwise as to the correctness of each of them; no person in the employment of Robert Cooney has any authority to make or give any representation or warranty whatever in relation to this property; we have not carried out a detailed survey nor tested the services, appliances and specific fittings.

