

*tavistockbow*

**For Rent**



**People Make Places**



**Gerrard Street, Chinatown W1**

1 bedroom | 463 sq ft

£590 pw





This one-bedroom apartment in Chinatown has been thoughtfully designed to maximise space. The smart white kitchen is separate from the living room, the double bedroom at the back of the property and contemporary shower room. Available early May, unfurnished.

#### What you need to know

- One bedroom
- One shower room
- Recently refurbished
- 3rd floor, walk-up
- Wood floors throughout
- Unfurnished
- Secondary glazing
- Contemporary
- Available early May
- Close to Piccadilly Circus and Leicester Square underground stations





### Overview

Located on the third floor, walk-up, this one-bedroom apartment has a modern feel throughout. Wide wooden floors feature in the reception and bedroom, while the bathroom has stylish mosaic tiles on the floor and square underground white wall tiles with grey grout to complement the smart walk-in shower complete with rainfall shower.

Gerrard Street is positioned at the heart of Chinatown's vibrancy. The choice in Eastern restaurants is endless, with the fluffy steam buns of Bun House within walking distance, as well as many hole-in-the-wall food outlets serving Eastern delicacies from bubble tea to sweet desserts like waffles and jianbing pancakes, a popular breakfast dish in China.

The apartment is available early May on an unfurnished basis. Subject to contract and satisfactory references. Westminster Council tax band: E.



# People Make Places

London is a collection of inspiring urban villages and one of the most exciting places in the world to live, work & play.

We work with both property owners and their occupiers, sharing the story of these vibrant neighbourhoods, conveying the unique soul & energy to future custodians, the people who'll keep them buzzing.

And unlike many real estate businesses we're not just about buildings, because streets & buildings don't make a neighbourhood.

We're about building relationships, because **people make places**.

MISINTERPRETATION ACT (COPYRIGHT) DISCLAIMER: Tavistock Bow Ltd for themselves and for the vendor(s) of this property whose agents they are, given notice that: 1. These particulars do not constitute, nor constitute any part of, an offer or contract. 2. None of the statements contained in these particulars as to the property are to be relied on as statements or representations of fact. 3. Any intending purchaser or lessee must satisfy themselves by inspection or otherwise as to the correctness of each of the statements contained in these particulars. 4. The vendor(s) or lessor(s) do not make or give and neither Tavistock Bow Ltd nor any person in their employment has any authority to make or give any representation or warranty whatever in relation to this property. Finance Act 1989, Unless otherwise stated all prices and rents are quote exclusive of VAT. Property Misrepresentation Act 1991; These details are believed to be correct at the time of compilation but may be subject to subsequent amendment.

Follow us:     @tavistockbow

Score	Energy rating	Current	Potential
92+	A		
81-91	B		
69-80	C		
55-68	D	66 D	66 D
39-54	E		
21-38	F		
1-20	G		

Gerrard Street, W1

Approximate Gross Internal Area 43 sq m / 463 sq ft

Third Floor

- 1 Kitchen  
2.10 x 1.89M  
6'11" x 6'2"
- 2 Reception Room  
5.13 x 3.62M  
16'10" x 11'11"
- 3 Bedroom  
3.80 x 3.24M  
12'6" x 10'8"

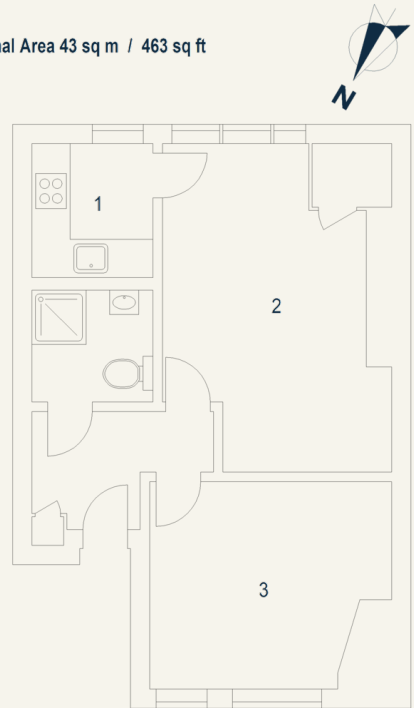

Floor Plan produced for Tavistock Bow by Mays Floorplans © . Tel 020 3397 4594  
Illustration for identification purposes only, not to scale.

**tavistockbow**

21 New Row, Covent Garden,  
London, WC2N 4LE

t: 020 7477 2177  
e: hello@tavistockbow.com  
w: tavistockbow.com



**Gerrard Street, Chinatown W1**