



STEPHENSON BROWNE

## Dane Close, Alsager

ST7 2HZ



**£1,195 PCM**

## Description

A fantastic opportunity to rent a three bedroom detached family home in Alsager which features a garage and a conservatory to the rear!

Well-presented throughout and featuring a recently installed kitchen, this stylish home would make an ideal family home.

An entrance hallway leads to a spacious lounge, which opens into a separate dining room, with a conservatory to the rear and a gorgeous and well-proportioned kitchen completing the ground floor. Upstairs, there are three bedrooms (two doubles and one single) and a family bathroom. Ample off-road parking is provided via a paved driveway and an integral garage, whilst the rear garden features lawned and patio areas with mature border shrubs and gated side access.

Situated on Dane Close, the property is ideally placed for the wealth of amenities within Alsager, including several schools such as Cranberry Academy and Alsager School. Leisure facilities such as Alsager Leisure Centre and Alsager Sports Hub are also within easy reach.

A superb family home which must be seen to be fully appreciated! Please contact Stephenson Browne to arrange your viewing.



## Viewing

Please contact our office using the details provided on the final page if you are interested in booking a viewing or require further information.

# Floorplans

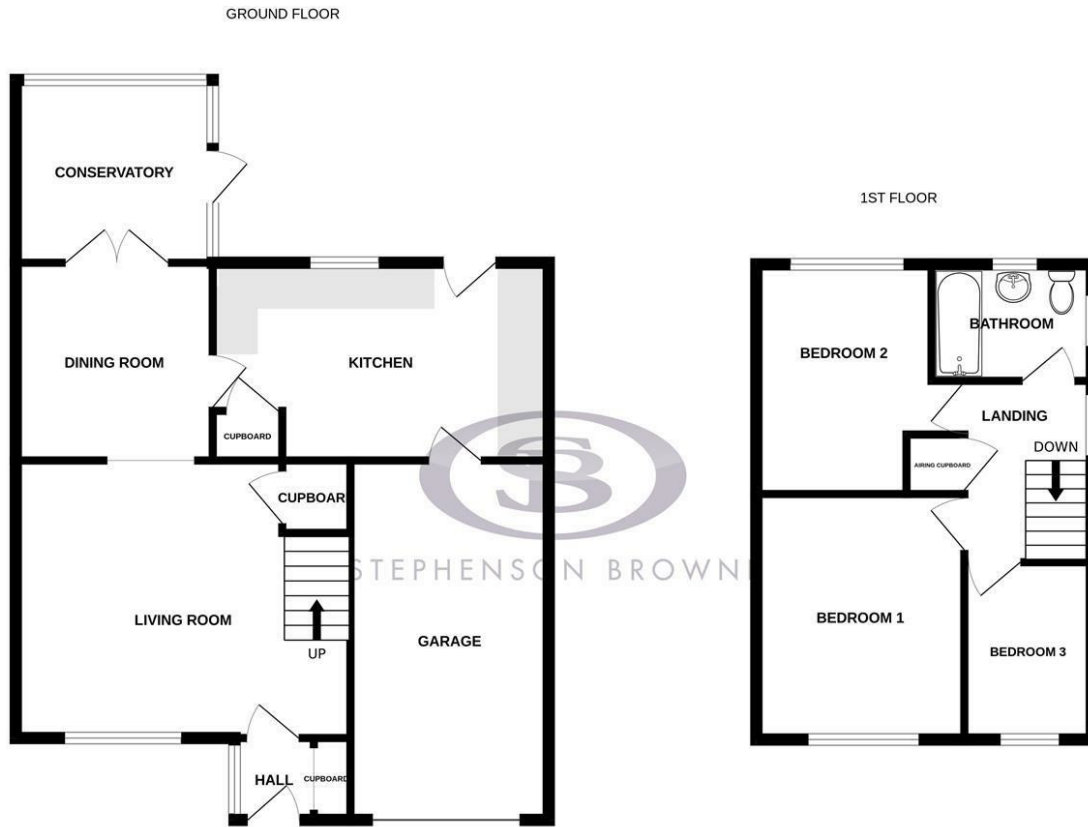

Whilst every attempt has been made to ensure the accuracy of the floorplan contained here, measurements of doors, windows, rooms and any other items are approximate and no responsibility is taken for any error, omission or mis-statement. This plan is for illustrative purposes only and should be used as such by any prospective purchaser. The services, systems and appliances shown have not been tested and no guarantee as to their operability or efficiency can be given.  
Made with Metropix ©2025

# Area Map



Energy Efficiency Rating	
Current	Potential
Very energy efficient - lower running costs	
(92 plus) <b>A</b>	83
(81-91) <b>B</b>	
(69-80) <b>C</b>	
(55-68) <b>D</b>	
(39-54) <b>E</b>	
(21-38) <b>F</b>	
(1-20) <b>G</b>	
Not energy efficient - higher running costs	
70	
EU Directive 2002/91/EC	

Environmental Impact (CO <sub>2</sub> ) Rating	
Current	Potential
Very environmentally friendly - lower CO <sub>2</sub> emissions	
(92 plus) <b>A</b>	
(81-91) <b>B</b>	
(69-80) <b>C</b>	
(55-68) <b>D</b>	
(39-54) <b>E</b>	
(21-38) <b>F</b>	
(1-20) <b>G</b>	
Not environmentally friendly - higher CO <sub>2</sub> emissions	
EU Directive 2002/91/EC	

NOTICE: Stephenson Browne for themselves and for the vendors or lessors of this property whose agents they are give notice that: (1) the particulars are set out as a general guideline only for the guidance of intending purchasers or lessees, and do not constitute, nor constitute part of, an offer or contract; (2) all descriptions, dimensions, references to condition and necessary permissions for use and occupation, and other details are given in good faith and are believed to be correct but any intending purchasers or tenants should not rely on them as statements or representations of fact but must satisfy themselves by inspection or otherwise as to the correctness of each theme; (3) no person in the employment of Stephenson Browne has any authority to make representation or warranty whatever in relation to this property. (4) fixtures & fittings are subject to a formal list supplied by the vendors solicitors. **Referring to:** Move with Us Ltd **Average Fee:** £123.64

T: 01270 883130 opt 2 E: alsagerlettings@stephensonbrowne.co.uk

www.stephensonbrowne.co.uk