



Connells

Wrens Nest Road
Dudley



Property Description

This elegantly presented three-bedroom semi-detached home is situated in a sought-after residential neighbourhood. The property boasts generous living spaces, making it an ideal choice for families. Its advantageous location provides easy access to bus routes, with Coseley train station nearby, as well as local schools and various amenities.

Entrance Porch

Double glazed door to the front elevation, double glazed window to the front.

Entrance Hall

Double glazed door & window to the front elevation, stairs to first floor accommodation, vertical central heating radiator.

Lounge

9' 10" x 9' 2" (3.00m x 2.79m)

Double glazed bay window to the front elevation, central heating radiator.

Dining Room

11' 6" x 9' 2" (3.51m x 2.79m)

Archway to kitchen, central heating radiator.

Kitchen

16' 5" (max) x 14' 9" (max) (5.00m (max) x 4.50m (max))

A fitted gloss kitchen to include wall and base units with work surfaces over, sink & drainer unit with mixer tap over, electric cooker point, plumbing for washing machine, space for domestic appliances, built-in storage cupboard, double glazed window to the rear & side, double glazed door to the rear leading to garden.

First Floor

Landing

Double glazed window to the side.

Bedroom One

11' 10" x 9' 10" (3.61m x 3.00m)

Double glazed window to the rear elevation, central heating radiator.

Bedroom Two

9' 10" x 9' 10" (3.00m x 3.00m)

Double glazed window to the front elevation, central heating radiator.

Bedroom Three

6' 7" x 5' 11" (2.01m x 1.80m)

Double glazed window to the front, central heating radiator.

Bathroom

Bath, wash hand basin, low level w.c., built-in storage cupboard, double glazed window to the rear.

Outside

To the front of the property block paved driveway giving off road parking, bark detail & side access to rear garden. Rear garden having patio area, step approach to decking area, lawn, further decking area with summerhouse.

Private Right Of Way

There is a easement on the title, please enquire with the branch.







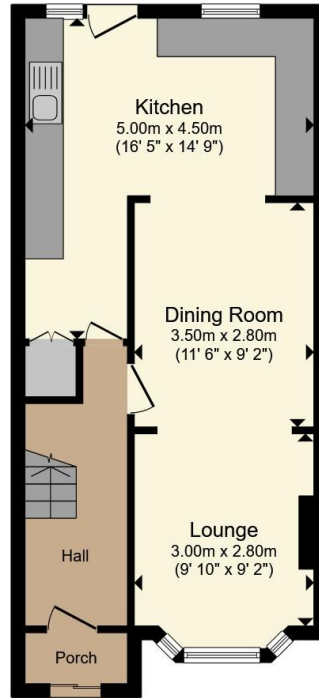

Ground Floor

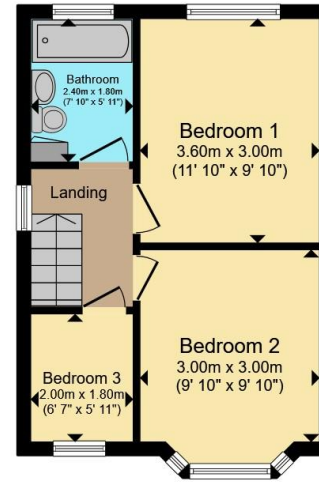

First Floor

Total floor area 74.9 m² (807 sq.ft.) approx

This floor plan is for illustrative purposes only. It is not drawn to scale. Any measurements, floor areas (including any total floor area), openings and orientation are approximate. No details are guaranteed, they cannot be relied upon for any purpose and they do not form part of any agreement. No liability is taken for any error, omission or misstatement. A party must rely upon its own inspection(s). Powered by www.propertybox.io



To view this property please contact Connells on

T 01384 214 770
E dudley@connells.co.uk

4 & 5 Stone Street
 DUDLEY DY1 1NS

EPC Rating: D Council Tax
 Band: A

Tenure: Freehold

view this property online connells.co.uk/Property/DUD314475



1. MONEY LAUNDERING REGULATIONS Intending purchasers will be asked to produce identification documentation at a later stage and we would ask for your co-operation in order that there will be no delay in agreeing the sale. 2. These particulars do not constitute part or all of an offer or contract. 3. The measurements indicated are supplied for guidance only and as such must be considered incorrect. Potential buyers are advised to recheck measurements before committing to any expense. 4. We have not tested any apparatus, equipment, fixtures, fittings or services and it is in the buyers interest to check the working condition of any appliances.

Connells Residential is registered in England and Wales under company number 1489613, Registered Office is Cumbria House, 16-20 Hockliffe Street, Leighton Buzzard, Bedfordshire, LU7 1GN. VAT Registration Number is 500 2481 05.

See all our properties at www.connells.co.uk | www.rightmove.co.uk | www.zoopla.co.uk

Property Ref: DUD314475 - 0005