



Melbourne Avenue, W13

£325,000

Offers In Excess Of

Well presented first floor apartment offered to the market, providing stylish and modern living in a great location and excellent condition. The property comprises an open plan kitchen and living area, a double bedroom and a contemporary bathroom.



Close to both Oaklands and Fielding Primary Schools, and situated between Northfields Avenue and Boston Road, this location offers excellent transport links and convenient local amenities.

- Share Of Freehold • Open Plan Kitchen/Living Area • Contemporary Bathroom •
- High Specification Finish • Period Property • Good Transport Links •



First Floor

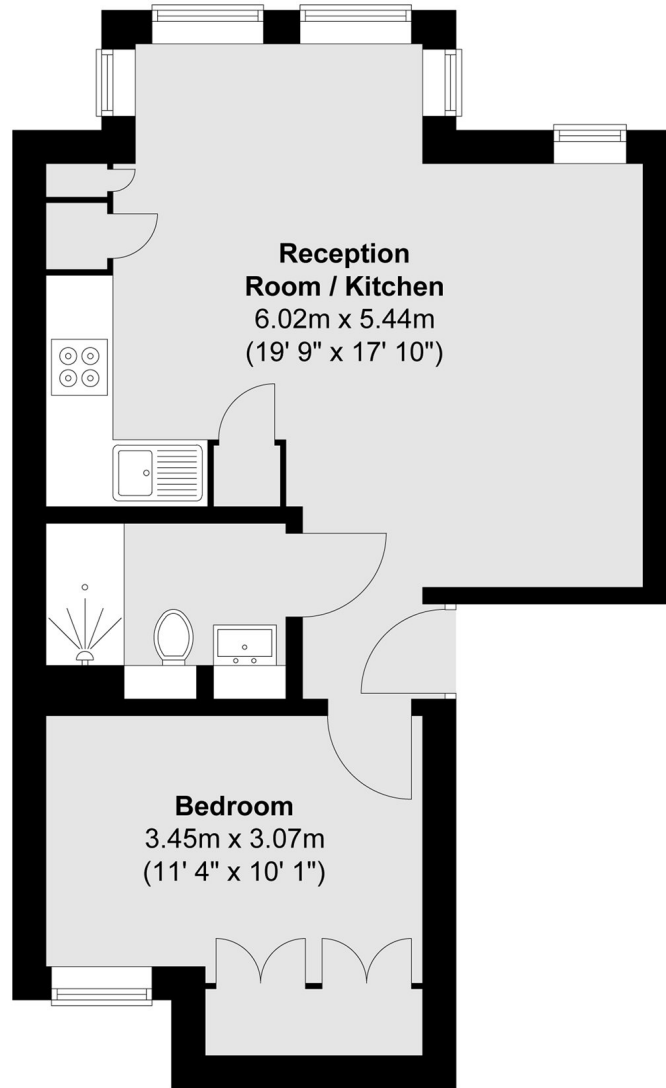

Total area (approx.) : 37.5 sq. m (403 sq. ft)

Robertson Smith & Kempson Northfields Sales
116 Northfield Avenue,
London, W13 9RT
020 8566 2340
northfieldssales@robertsonsmithandkempson.co.uk

Energy Rating: C. We aim to make our particulars both accurate and reliable. However they are not guaranteed; nor do they form part of an offer or contract. If you require clarification on any points then please contact us, especially if you're traveling some distance to view. Please note that appliances and heating systems have not been tested and therefore no warranties can be given as to their good working order.