



## Room 2, 14 Union Terrace, Leeds, West Yorkshire, LS7 3DN

Available 5th September 2026 All bills and communal cleaner included.

A large double bedroom to rent in a spacious five bedroom, three bathroom shared house in Chapel Allerton. The first floor bedroom is fully furnished and includes a corner sink unit.

The house benefits from a large living room with a recently installed kitchen, dining room and laundry to the lower ground floor. There is extra storage and a secure private bike store included.

Union Terrace is located within the residential heart of Chapel Allerton, with the main high street less than 0.2m away.

On street parking is available and regular bus routes into town depart from Harrogate Road less than 0.2m away.

**£595 Per month**

BASEMENT  
225 sq.ft. (20.5 sq.m.) approx.



GROUND FLOOR  
389 sq.ft. (35.5 sq.m.) approx.

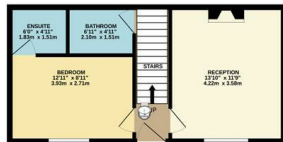

1ST FLOOR  
393 sq.ft. (36.5 sq.m.) approx.

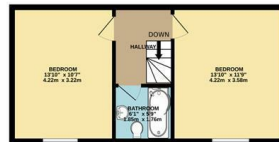

2ND FLOOR  
393 sq.ft. (36.5 sq.m.) approx.

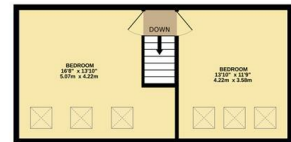

TOTAL FLOOR AREA: 1395 sq.ft. (129.6 sq.m.) approx.

Whilst every attempt has been made to ensure the accuracy of the floorplan contained here, measurements of doors, windows, rooms and any other items are approximate and no responsibility is taken for any error, omission or mis-statement. This plan is for illustrative purposes only and should be used as such by any prospective purchaser. The services, systems and appliances shown have not been tested and no guarantee as to their operability or efficiency can be given.

Made with Metropix ©2023

Energy Efficiency Rating		Current	Potential
Very energy efficient - lower running costs			
(92 plus) <b>A</b>			
(81-91) <b>B</b>			
(69-80) <b>C</b>			
(55-68) <b>D</b>			
(39-54) <b>E</b>			
(21-38) <b>F</b>			
(1-20) <b>G</b>			
Not energy efficient - higher running costs			
<b>England &amp; Wales</b>	EU Directive 2002/91/EC		

Environmental Impact (CO <sub>2</sub> ) Rating		Current	Potential
Very environmentally friendly - lower CO <sub>2</sub> emissions			
(92 plus) <b>A</b>			
(81-91) <b>B</b>			
(69-80) <b>C</b>			
(55-68) <b>D</b>			
(39-54) <b>E</b>			
(21-38) <b>F</b>			
(1-20) <b>G</b>			
Not environmentally friendly - higher CO <sub>2</sub> emissions			
<b>England &amp; Wales</b>	EU Directive 2002/91/EC		