



Darwin Court, Darwin Crescent, Torquay – TQ2 7FN
£165,000





Darwin Court, Darwin Crescent

Torquay, Torquay

Top floor | Two double bedrooms | Open-plan living | Juliet balcony with field views | Car port + allocated parking | Small 2010 development | Recently redecorated | Move-in ready | Secure entry | Ideal first purchase
Council Tax band: B

Tenure: Leasehold

EPC Energy Efficiency Rating:

EPC Environmental Impact Rating:

- Top floor position within a small development of just nine apartments, built by Cavanna in 2010
- Car port plus additional allocated parking space
- Attractive outlook across surrounding fields and countryside.
- Bright open-plan living space with modern kitchen
- Juliet balcony enjoying elevated views
- Two double bedrooms
- Bathroom with bath, shower and heated towel radiator
- Secure entry system and well-kept communal areas
- Recently redecorated and ready for immediate occupation



Darwin Court, Darwin Crescent

Torquay, Torquay

Darwin Crescent is well placed for access into Torquay town centre, the seafront and harbour, as well as local shops and everyday amenities. The Willows retail park is within easy reach for larger supermarkets and national stores. Local bus routes operate nearby, with Torquay train station providing connections to Exeter, Bristol and London Paddington. The South Devon Highway offers straightforward road links to Exeter and the M5 beyond, making it practical for commuters while still enjoying a quieter residential setting.

Absolute Sales & Lettings

Absolute Sales & Lettings Ltd, 13 Ilsham Road - TQ1 2JG

01803 214214

torquay@movewithabsolute.co.uk

movewithabsolute.co.uk/



Top Floor

Approx. 58.5 sq. metres (629.4 sq. feet)

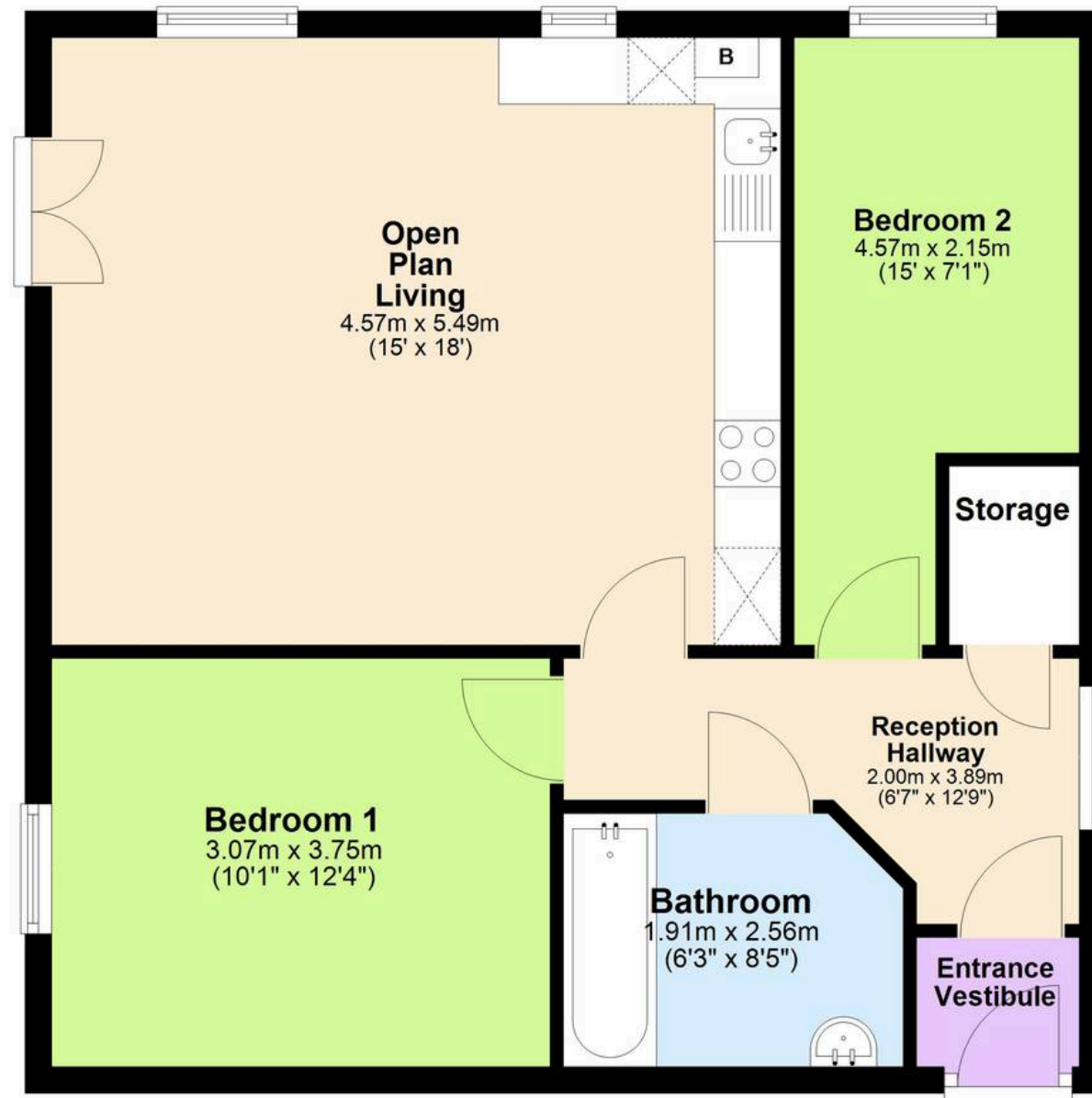

Total area: approx. 58.5 sq. metres (629.4 sq. feet)

