



ICONIC
ESTATE AGENTS

Wood View Road, Hellesdon
£300,000 - Freehold



- Conveniently Positioned Detached Bungalow
- Three Bedrooms
- Kitchen/Breakfast Room
- Spacious Lounge
- Modern Shower Room
- Enclosed Rear Garden
- 41ft Tandem Garage/Workshop
- Offered With No Onward Chain
- Early Viewing Highly Recommended
- EPC Rating Tbc / Council Tax Band C



GROUND FLOOR

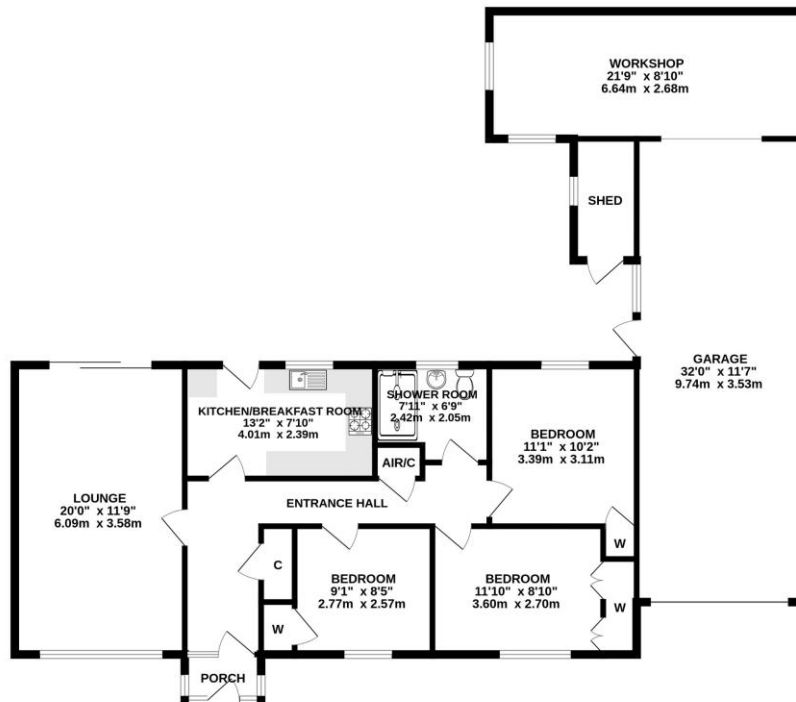

From Reepham Road, when leaving Norwich go straight over the Middletons Lane Roundabout and take the first left hand turning into Wood View Road where the property can be found indicated by our For Sale Board on the left-hand side.

"In accordance with the Estate Agents Act 1979, we disclose that the vendor is associated with Iconic estate Agents."

Viewings strictly by appointment with: 297 Fakenham Road, Norwich, NR8 6LE

Taverham **01603 261104**
Norwich **01603 740044**



We bring to prospective purchasers attention that we, as estate agents for the property, have not tested any appliances and purchasers should make their own enquiries of the relevant Authorities regarding the connection and viability of all services. These particulars, whilst believed to be accurate are set out as a general outline only for guidance and do not constitute any part of an offer or contract. Intending purchasers should not rely on them as statements of representation of fact, but must satisfy themselves by inspection or otherwise as to their accuracy.