



PRG
PROPERTY

14 The Lane, Chalton, Bedfordshire, LU4 9UE
£1,400

- EXCLUSIVE TO PR PROPERTY
- PRIVATE REAR GARDEN
- CLOSE TO M1 AND TRANSPORT LINKS

- 3 BEDROOMS
- NEWLY REFURBISHED
- ON ROAD PARKING

- AVAILABLE FEBRUARY 2026
- VILLAGE OF CHALTON
- MUST BE VIEWED

Exclusive to PR Property – A beautifully refurbished three bedroom house nestled in the charming village of Chalton, available from February 2026. This delightful home offers the perfect blend of peaceful village living with excellent transport connections to the M1, making it ideal for commuters and families alike. The property boasts a private rear garden, perfect for relaxing or entertaining, while the recent refurbishment ensures a fresh, modern feel throughout. With on street parking and a welcoming village atmosphere, this property truly offers a lifestyle to be envied. At £1,400 per calendar month, this is a rare opportunity to secure a quality home in a sought after location. Early viewing is absolutely essential.

LOUNGE/DINER 22'8" X 11'11" (6.92 X 3.62)

KITCHEN 12'8" X 7'4" (3.87 X 2.23)

BATHROOM

FIRST FLOOR

LANDING

BEDROOM 1 11'11" X 11'2" (3.62 X 3.40)

BEDROOM 2 11'3" X 6'4" (3.42 X 1.93)

BEDROOM 3 9'0" X 7'4" (2.75 X 2.23)

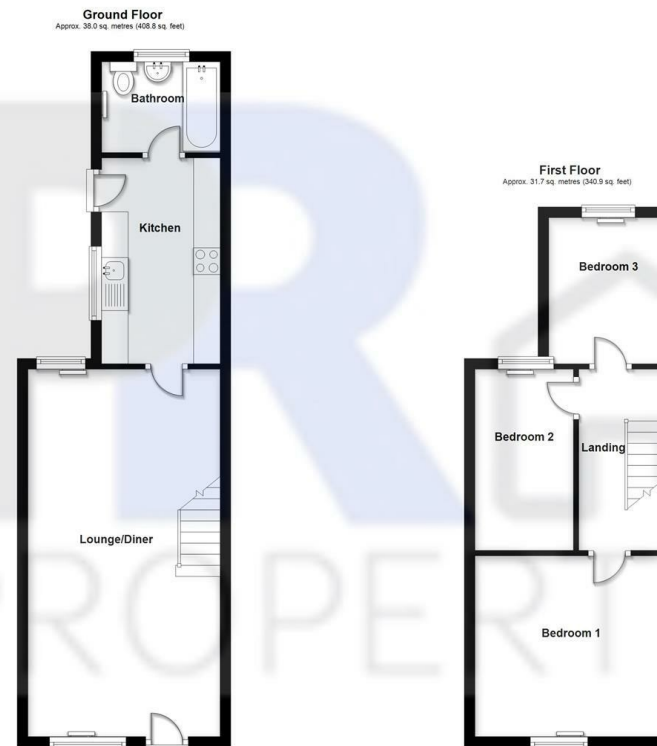

Total area: approx. 69.7 sq. metres (749.7 sq. feet)
14 the lane

Energy Efficiency Rating		Current	Potential
Very energy efficient - lower running costs			
(92 plus) A			86
(81-91) B			
(69-80) C			
(55-68) D		62	
(39-54) E			
(21-38) F			
(1-20) G			
Not energy efficient - higher running costs			
England & Wales		EU Directive 2002/91/EC	