



Orsett Terrace, W2 £400,000

A well-presented one bedroom apartment in a purpose built, portered block (with a lift). The property has a generously sized reception with wooden flooring and room to dine, a separate kitchen and built-in wardrobes in the bedroom. Hot water and heating are included in the service charge.

Located close to Paddington station with direct links to Heathrow Express. Close to Royal Oak, Hyde Park and the amenities and regeneration in Bayswater.

Features

- One Bedroom
- Portered Block
- Separate Kitchen
- Lift
- Hyde Park
- Paddington

Orsett Terrace, London, W2

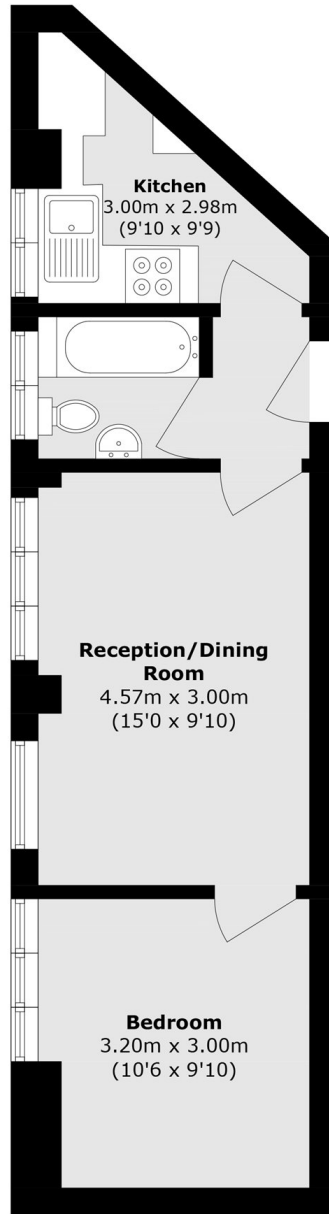

Third Floor

Total area (approx.): 35.0 sq. m (376.7 sq. ft)