



STEPHENSON BROWNE

**Homeshire House,
Alsager**
ST7 2LP



£65,000

Description

A well presented, conveniently located second floor apartment forming part of the popular 'Homeshire House' Retirement Development, originally constructed by MCARTHY AND STONE and positioned just a short walk from Alsager Village Centre amidst mature leafy surroundings.

This particular apartment benefits from views over communal gardens, with a further outlook towards period properties on the neighbouring Ashmores Lane.

Upon entry to the apartment, you will find: an entrance hall with useful storage/utility cupboard space, a spacious open plan lounge/dining Room and a kitchen with plenty of storage and an electric hob. The bedroom enjoys a fitted chest of drawers, wardrobes and mirror unit, in addition to the standard, substantially sized built-in wardrobes! There is also a convenient bathroom with white sanitary suite, including a bath with an overhead shower. Electric radiators with thermostatic controls can be found in the living room and bedroom, with an electric heater in the bathroom.

Access to the Residents Lounge can be found on the Ground Floor offering a sociable environment if desired, as well as wash room and guest suite for when you host family! A Development Manager can be contacted from various points within each property in the case of an emergency. For periods when the Development Manager is off duty, there is a 24 hour emergency Appello call system.

It is a condition of purchase that residents be over the age of 60 years, or in the event of a couple, one must be over the age of 60 years and the other over 55 years.



To truly appreciate the standard of this apartment, viewings come highly recommended. Call Stephenson Browne today to arrange yours!



Viewing

Please contact our office using the details provided on the final page if you are interested in booking a viewing or require further information.

Floorplans

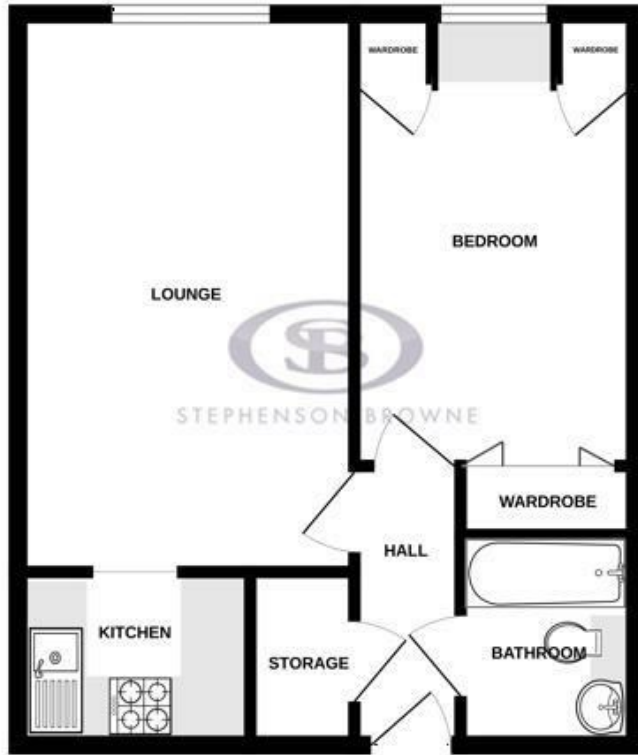

While every attempt has been made to ensure the accuracy of the floorplan contained here, measurements of doors, windows, stairs and any other items are approximate and no responsibility is taken for any error, omission or mis-statement. This plan is for illustrative purposes only and should be used as such by any prospective purchaser. The services, systems and equipment shown have not been tested and no guarantee as to their operability or efficiency can be given. Made with Maplogic ©2025

Area Map



| Energy Efficiency Rating | | Current | Potential |
|---|--|-------------------------|-----------|
| Very energy efficient - lower running costs | | | |
| (92 plus) A | | | |
| (81-91) B | | | |
| (69-80) C | | | |
| (55-68) D | | | |
| (39-54) E | | | |
| (21-38) F | | | |
| (1-20) G | | | |
| Not energy efficient - higher running costs | | | |
| England & Wales | | EU Directive 2002/91/EC | |

| Environmental Impact (CO ₂) Rating | | Current | Potential |
|---|--|-------------------------|-----------|
| Very environmentally friendly - lower CO ₂ emissions | | | |
| (92 plus) A | | | |
| (81-91) B | | | |
| (69-80) C | | | |
| (55-68) D | | | |
| (39-54) E | | | |
| (21-38) F | | | |
| (1-20) G | | | |
| Not environmentally friendly - higher CO ₂ emissions | | | |
| England & Wales | | EU Directive 2002/91/EC | |

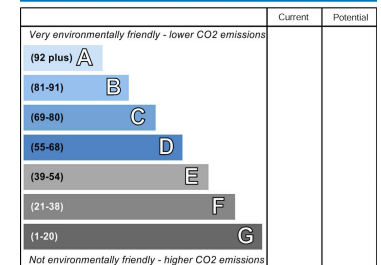
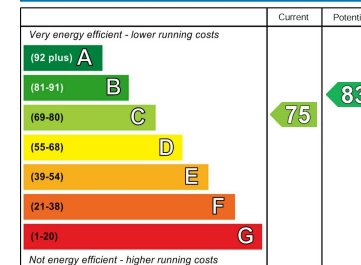

NOTICE: Stephenson Browne for themselves and for the vendors or lessors of this property whose agents they are give notice that: (1) the particulars are set out as a general guideline only for the guidance of intending purchasers or lessees, and do not constitute, nor constitute part of, an offer or contract; (2) all descriptions, dimensions, references to condition and necessary permissions for use and occupation, and other details are given in good faith and are believed to be correct but any intending purchasers or tenants should not rely on them as statements or representations of fact but must satisfy themselves by inspection or otherwise as to the correctness of each theme; (3) no person in the employment of Stephenson Browne has any authority to make representation or warranty whatever in relation to this property. (4) fixtures & fittings are subject to a formal list supplied by the vendors solicitors. **Referring to:** Move with Us Ltd **Average Fee:** £123.64

T: 01270 883130 E: alsager@stephensonbrowne.co.uk

www.stephensonbrowne.co.uk