



Jordan fishwick

4 Seymour House Tudor Road, SK9 2HB
Guide Price £129,950



Tudor Road Wilmslow SK9 2HB

Guide Price £129,950



Set within a quiet and well maintained cul-de-sac, this attractive ground floor studio apartment offers smart, low-maintenance living in a highly convenient location. The accommodation is thoughtfully arranged to maximise space and functionality, featuring a bright open-plan living and sleeping area alongside a contemporary fitted kitchen with integrated appliances. The property also benefits from useful built-in storage, creating a practical and comfortable home. Ideally positioned for commuters, the apartment provides excellent access to the A34, M56 and surrounding motorway network, with Manchester Airport also within easy reach. Wilmslow town centre is nearby and offers a wide range of amenities including shops, cafés, restaurants and leisure facilities, while Wilmslow railway station provides direct services to Manchester city centre and London Euston. An ideal purchase for first-time buyers, investors or those seeking a conveniently located apartment in a desirable area.



- Studio Apartment
- Ground Floor
- Close Proximity To Amenities
- Bathroom
- Fitted Kitchen
- Cul de Sac position
- Parking



Energy Efficiency Rating		
	Current	Potential
Very energy efficient - lower running costs		
(92 plus) A		
(81-91) B		
(69-80) C		
(55-68) D		
(39-54) E		
(21-38) F		
(1-20) G		
Not energy efficient - higher running costs		
England & Wales	EU Directive 2002/91/EC 	

GROUND FLOOR

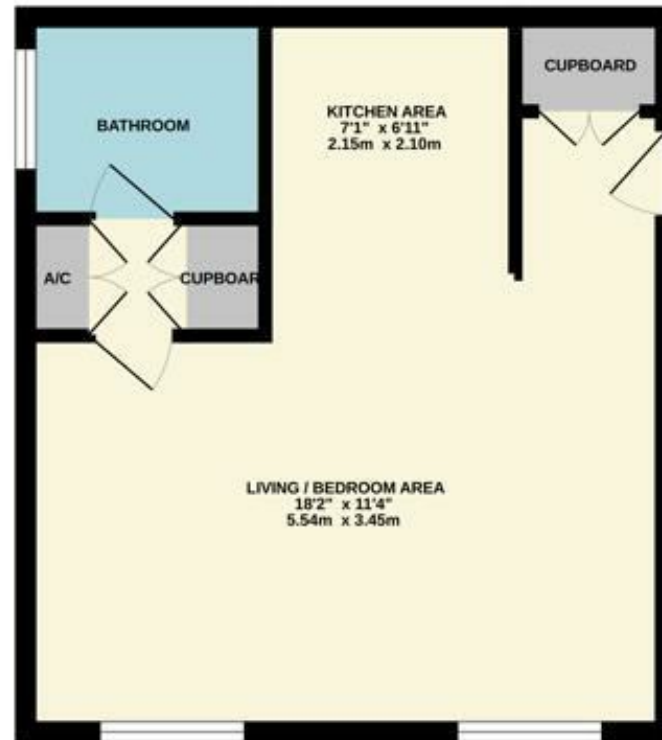

Measurements are approximate. Not to scale. Available pictures only.
Made with Metaphor 11/2021



These particulars are believed to be accurate but they are not guaranteed and do not form a contract. Neither Jordan Fishwick nor the vendor or lessor accept any responsibility in respect of these particulars, which are not intended to be statements or representations of fact and any intending purchaser or lessee must satisfy himself by inspection or otherwise as to the correctness of each of the statements contained in these particulars. Any floorplans on this brochure are for illustrative purposes only and are not necessarily to scale.

Offices at: Chorlton, Didsbury, Disley, Hale, Glossop, Macclesfield, Manchester Deansgate, Manchester Whitworth Street, New Mills, Sale, Wilmslow and Withington

36-38 Alderley Road, Wilmslow SK91JX
01625 532000

wilmslow@jordanfishwick.co.uk
www.jordanfishwick.co.uk