



## Sopwith Way, KT2

£425,000

A spacious two double bedroom apartment featuring a generous open-plan living and dining area leading into a modern kitchen. A standout feature of the property is the impressive private terrace, offering approximately 250 sq ft of additional usable space. Accessed directly from the living area and overlooked by both bedrooms, the terrace provides an excellent extension of the home, ideal for summer evenings and entertaining.

Regents Court is perfectly positioned just 150 yards to the station in the heart of Kingston town centre to enjoy the vast array of excellent shopping and social facilities Kingston has to offer. You are also just a short 500 yard stroll to the banks of the river Thames and Canbury Gardens.

### Features

- Two Double Bedrooms
- Excellent Condition
- Central Location
- Gated Development
- 250 sq.ft Private Terrace
- Residents Gymnasium

# Sopwith Way, Kingston Upon Thames, KT2

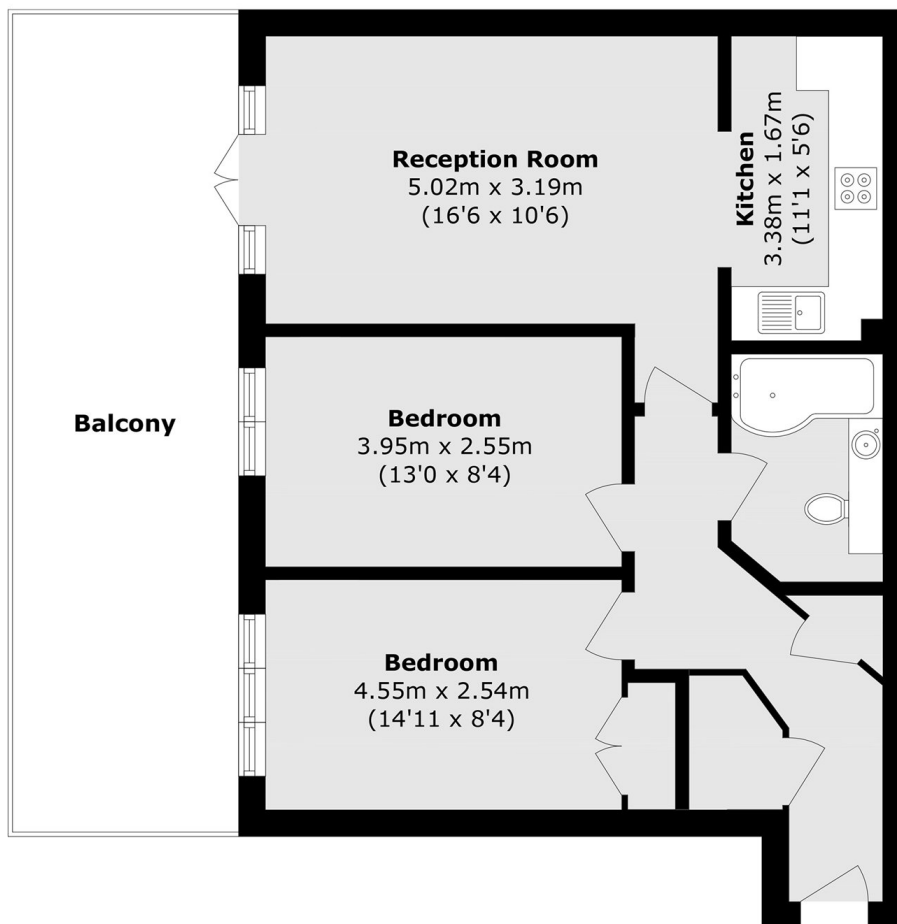

Total area (approx.): 59.9 sq. m (644.7 sq. ft)

Balcony area (approx.): 23.5 sq. m (252.9 sq. ft)