

**SW19**

*it's all in the postcode...*



**Noble Court,**  
261, Church Road

**Monthly Rental Of £1,650**

- Purpose built apartment
- Allocated parking
- Well presented
- Sought after location
- Available from 26th June
- 
- Council tax Band C
- EPC Rating



020 8544 2828

Wimbledon: Wimbledon Park: Colliers Wood

[www.SW19.com](http://www.SW19.com)

SW19 Estate Agents Ltd. Is registered in England & Wales No. 05508737

*it's all in the postcode...*

A beautifully presented two-bedroom purpose-built apartment, ideally located within a highly sought-after development. The property offers a spacious and bright lounge/dining area, perfect for both relaxing and entertaining, along with the added benefit of allocated parking. This is an excellent opportunity for renters looking to secure a home for many years to come. Don't miss out on this fantastic home.



020 8544 2828  
Wimbledon: Wimbledon Park: Colliers Wood  
[www.SW19.com](http://www.SW19.com)  
SW19 Estate Agents Ltd. Is registered in England & Wales No. 05508737

*'it's all in the postcode...'*

# Noble Court CR4

Approx. Gross Internal Area 570 Sq Ft - 52.95 Sq M

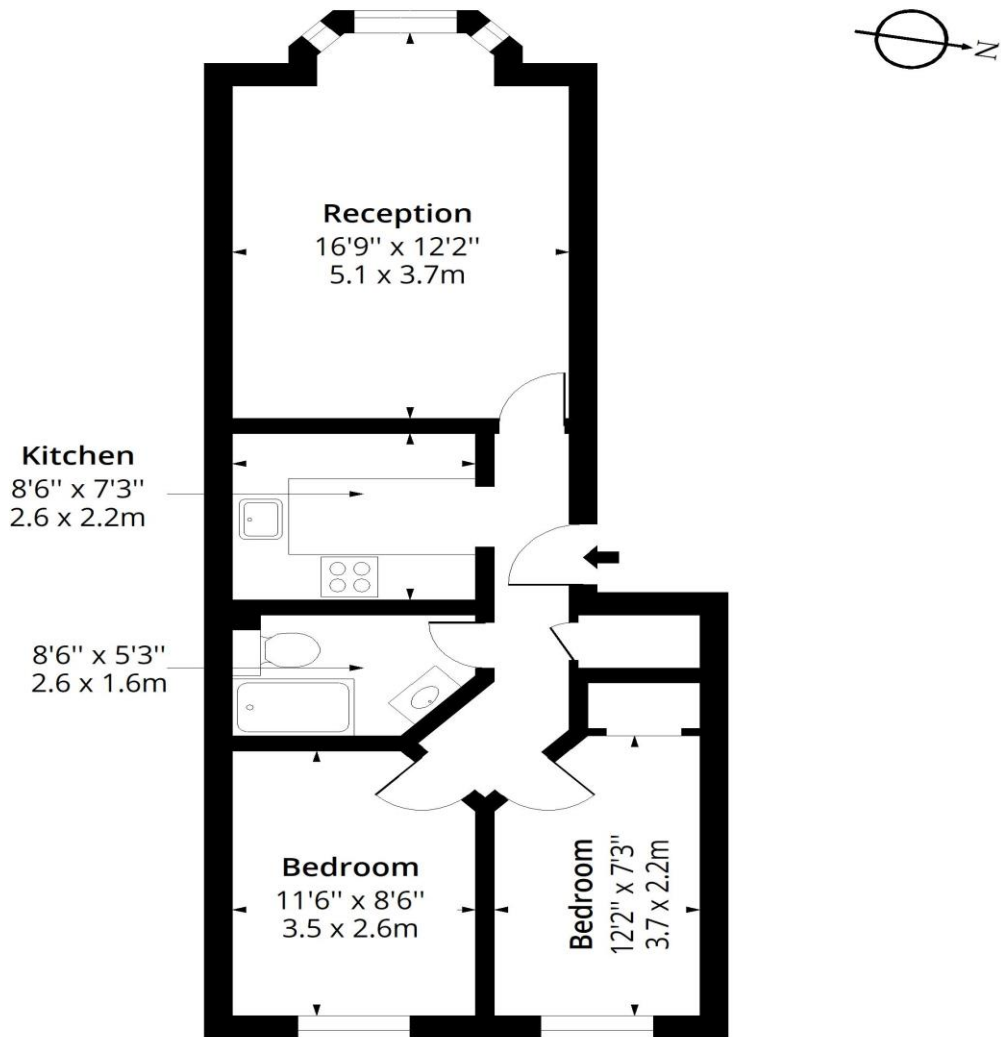

## Second Floor

Floor Area 570 Sq Ft - 52.95 Sq M



Measured according to RICS IPMS2. Floor plan is for illustrative purposes only and is not to scale. Every attempt has been made to ensure the accuracy of the floor plan shown, however all measurements, fixtures, fittings and data shown are an approximate interpretation for illustrative purposes only. 1 sq m = 10.76 sq feet.

lpaplus.com

Date: 7/4/2026

These particulars are for guidance only and should not be relied upon as a statement or representation of fact. All measurements given are approximate only and should not be relied upon for ordering carpets, equipment etc. Purchasers should satisfy themselves by inspection or otherwise as to the accuracy of the statements contained within. Neither SW19 estate agents ltd or related companies or their employees can confirm structural conditions of the property or that any appliances or other facilities are in working order. Purchasers are strongly recommended to arrange their own survey.

020 8544 2828  
Wimbledon: Wimbledon Park: Colliers Wood  
www.SW19.com  
SW19 Estate Agents Ltd. Is registered in England & Wales No. 05508737

*'it's all in the postcode...'*