



59 Barry Crescent, Worsley

Offers Over £160,000

Miller Metcalfe
Every step of the way

59 Barry Crescent

Worsley, Manchester

* Calling All First Time Buyers and To Let Investors *

Early Viewing Strongly Advised - Fabulous Two Double Bedroomed Townhouse, Well Proportioned Accommodation, Spacious Bay Fronted Lounge, Separate Dining Area, Fitted Kitchen with Appliances, Two Generous Double Bedrooms plus a Three Piece Shower Room, Gardens to both the Front and Rear, Situated within in a Popular Residential Location - Simply Must be Viewed Internally to be Fully Appreciated.

Situated within a popular and highly convenient setting, this wonderful home offers exceptionally generous living space that is ideally suited to modern lifestyles and must be seen in person to be fully appreciate. The spacious accommodation comprises an entrance porch, hallway, superb light and bay fronted airy lounge, separate dining area, and a fitted kitchen to the ground floor. On the first floor a landing, two exceptionally good sized double bedrooms plus a three piece shower room/wc completes the internal living space.

Outside the property is garden fronted the rear garden offers excellent private space for children's play, relaxing and al-fresco entertaining.

The location is within easy access to the many shops and amenities Walkden, Little Hulton, Bolton, Worsley, Tyldesley, Swinton and the surrounding areas has to offer and is well placed for well renowned schooling. Excellent transport links provide easy travel into Manchester city centre, making it ideal for those looking to commute across the North West.

Rarely do homes of this type remain on the market for long especially at such an attractive price. As such, an early internal viewing is strongly advised to avoid disappointment.

Council Tax band: A

Tenure: Freehold

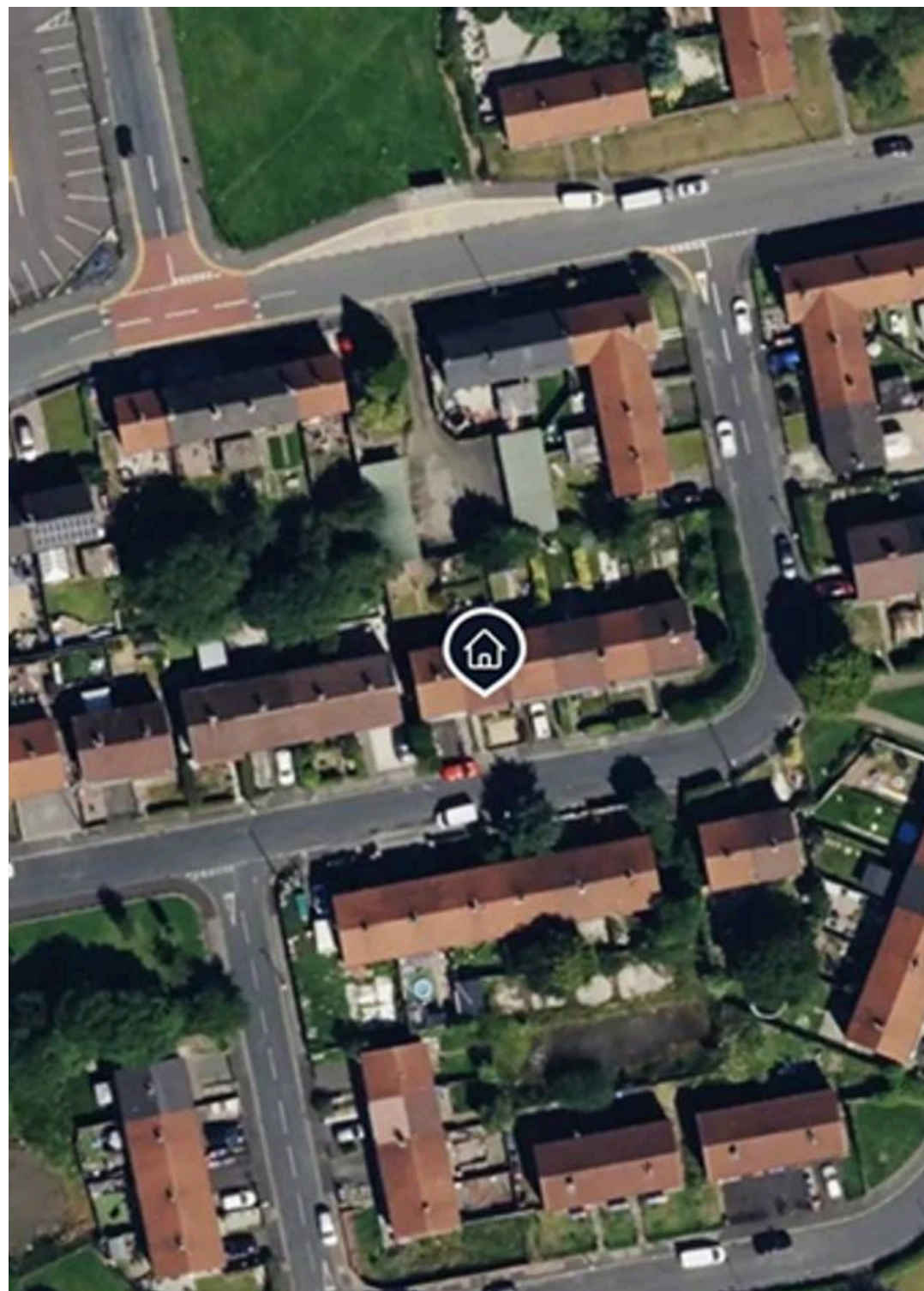









GROUND FLOOR
405 sq.ft. (37.6 sq.m.) approx.

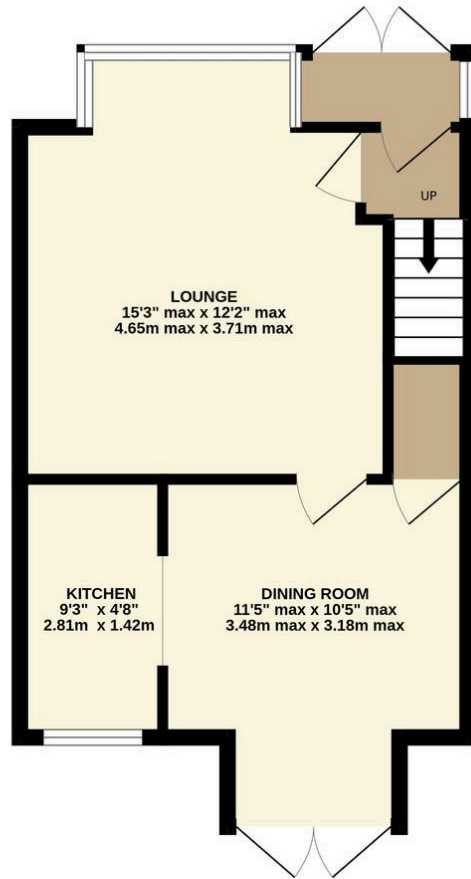

1ST FLOOR
385 sq.ft. (35.8 sq.m.) approx.



TOTAL FLOOR AREA : 790 sq.ft. (73.4 sq.m.) approx.

Whilst every attempt has been made to ensure the accuracy of the floorplan contained here, measurements of doors, windows, rooms and any other items are approximate and no responsibility is taken for any error, omission or mis-statement. This plan is for illustrative purposes only and should be used as such by any prospective purchaser. The services, systems and appliances shown have not been tested and no guarantee as to their operability or efficiency can be given.
Made with Metropix ©2026

Miller Metcalfe Worsley

78 Manchester Road, Worsley - M28 3LN

01617949798 • worsley@millermetcalfe.co.uk • millermetcalfe.co.uk/

Miller Metcalfe
Every step of the way