



House - Mid Terrace

# PRINCES ROAD, DARTFORD, DA1

## £1,900

### FEATURES

- Three bedrooms
- Ground floor W/C
- On-street parking
- Close to local amenities, schools, and transport links
- Spacious living room
- Private rear garden
- Popular residential location



BEXLEY HOMES

# 3 Bedroom House – Mid Terrace located in Dartford

3 Bedroom Family Home to Rent – Princes Road, Dartford.

Available to rent is this well-presented three-bedroom home, ideally located in a popular residential area of Dartford. Offering generous living space across two floors, this property is perfect for families or professional tenants.

The ground floor features a spacious and bright living room, ideal for both relaxing and entertaining, along with a well-proportioned kitchen providing ample storage and workspace. A convenient ground floor W/C adds to the practicality of the home.

Upstairs, the property comprises three bedrooms, including two good-sized doubles and a third single bedroom, suitable as a child's room, home office, or guest room. A family bathroom serves the first floor.

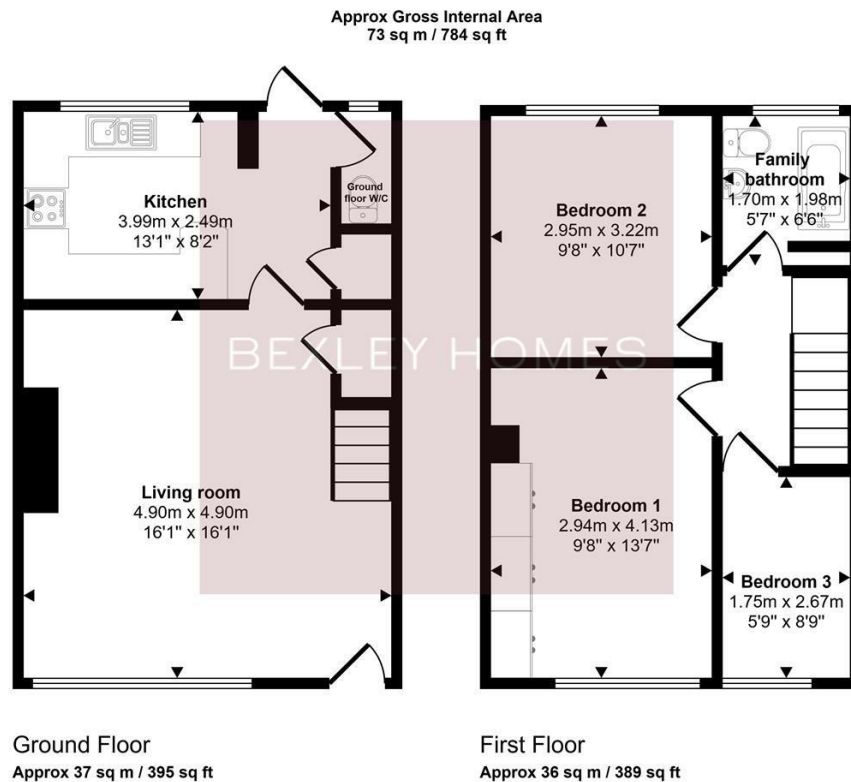

This floorplan is only for illustrative purposes and is not to scale. Measurements of rooms, doors, windows, and any items are approximate and no responsibility is taken for any error, omission or mis-statement. Icons of items such as bathroom suites are representations only and may not look like the real items. Made with Made Snappy 360.

Call us on  
01322 948500

Belvedere@bexleyhomes.co.uk  
www.bexleyhomes.co.uk

Council Tax Band

C

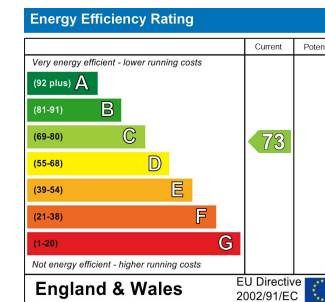

Agents Note: Whilst every care has been taken to prepare these particulars, they are for guidance purposes only. All measurements are approximate and are for general guidance purposes only and whilst every care has been taken to ensure their accuracy, they should not be relied upon and potential buyers are advised to recheck the measurements.

**BEXLEY HOMES**