



Guide Price
£215,000

Leasehold

2x  2x  1x 

**The Wharf, Dock Head
Road, Chatham, Kent,
ME4**

OVER 60?

Secure this property
for up to **59% less!**

Wards
Helping you move forwards



Main features

- Top floor flat with lift access
- Juliet balcony overlooking the basin
- Family bathroom and en-suite shower room
- Perfect for first time buyers or investors looking to add to their portfolio
- Fantastic location due to proximity to Dockside Outlet centre, cinema, gym, restaurants and transport links

Accommodation

THIRD FLOOR

- Entrance Hallway
- Kitchen/Living Area: 24'1 x 10'11 (7.35m x 3.33m)
- Juliet Balcony
- Bedroom 1: 15'1 x 11'7 (4.60m x 3.53m)
- En-suite Shower Room : 6'10 x 4'10 (2.08m x 1.47m)
- Bedroom 2: 13'10 x 6'4 (4.22m x 1.93m)
- Bathroom: 7'2 x 6'4 (2.19m x 1.93m)

OUTSIDE

- Allocated Parking

Third Floor

Approx. 68.5 sq. metres (737.6 sq. feet)

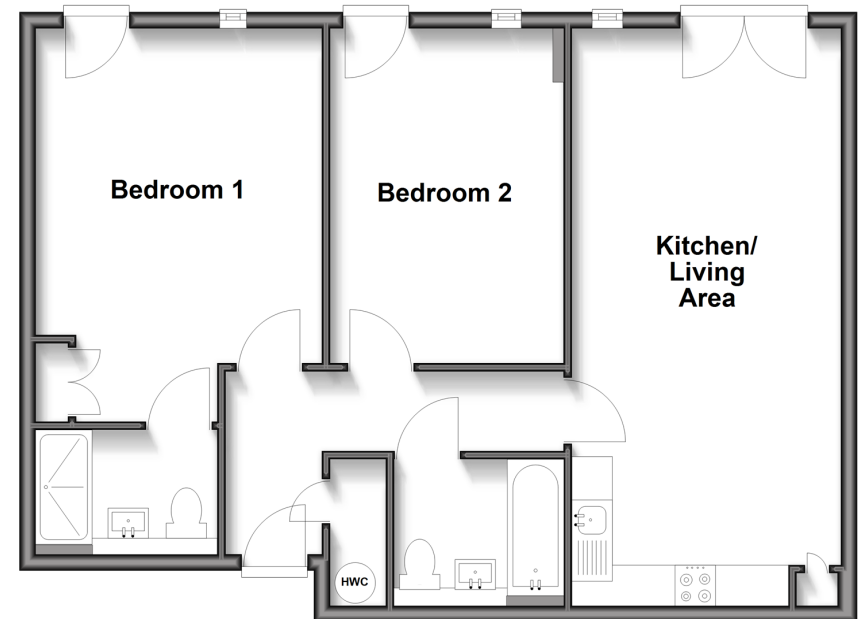

Call Chatham - 01634 841243 ■ wardsofkent.co.uk

- Legal advice should be taken to verify fixtures/fittings, planning, alterations and/or lease details
- Through a Homewise Home For Life Plan people aged 60+ can secure this property for up to 50% less, by purchasing a Lifetime Lease.

- Appliances & services are untested, dimensions are approximate and floor plans are not to scale



10435270/20251030/RC/RC