



24A New Cheltenham Road, Kingswood, Bristol, BS15

£162,500

Offered with no onward chain, is this fine one bedroom first floor flat. The property comprises hallway, stairs leading to spacious landing, living room, fitted kitchen, double bedroom with fitted wardrobes and a large bathroom. Other benefits include double glazing and modern electric heaters. Situated on this popular road, just off the main New Cheltenham road, in this pleasant backwater, yet close to local amenities, with a short commute to the ring road and motorway network. In our opinion this property would make a perfect first home. Early viewing Recommended. New 999 Year Lease. No service charge. Energy Rating E. Council Tax Band A.

- No Onward Chain
- One Double Bedroom
- Living Room
- Kitchen
- Bathroom
- Double Glazing
- Communal Front Garden
- Popular Location
- Close To Amenities
- Perfect Starter Home

Viewing

Please contact our Brunt & Fussell Ltd Office on 01179566004 if you wish to arrange a viewing appointment for this property or require further information.



1



1



1



E

Floor Plan

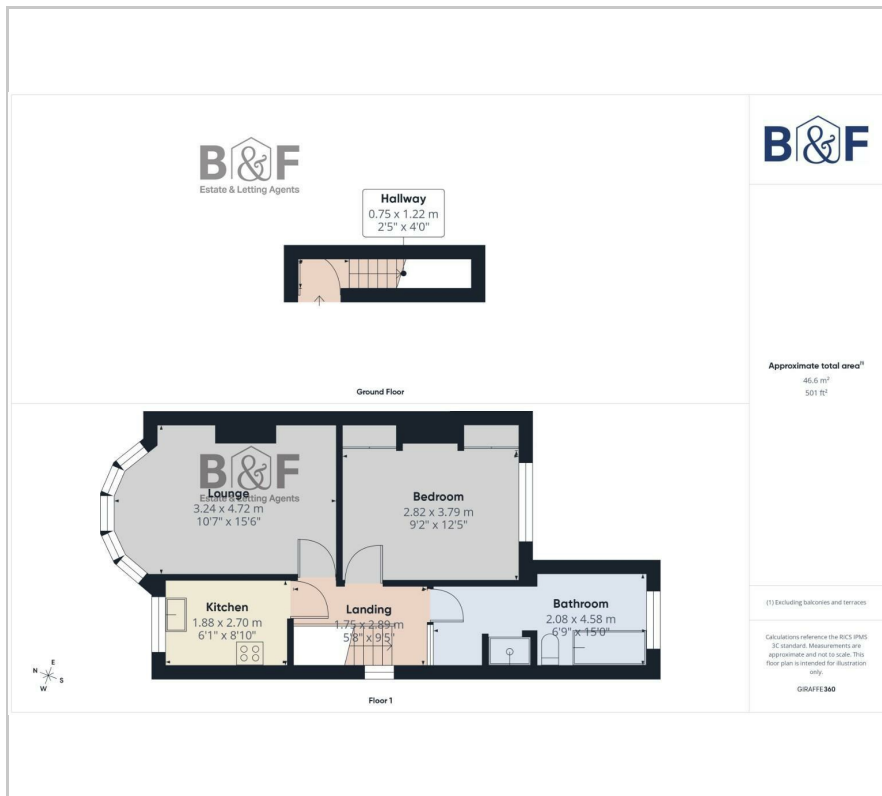

Area Map



Energy Efficiency Graph

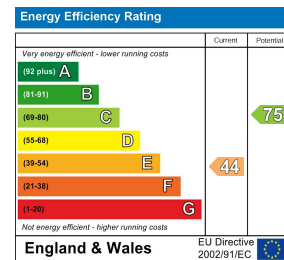

These particulars, whilst believed to be accurate are set out as a general outline only for guidance and do not constitute any part of an offer or contract. Intending purchasers should not rely on them as statements of representation of fact, but must satisfy themselves by inspection or otherwise as to their accuracy. No person in this firm's employment has the authority to make or give any representation or warranty in respect of the property.