



WESTWOODLEBER

WESTWOODLEBER
LET US GUIDE YOU HOME

Hillside, Hoddesdon, EN11 8RW
Offers in excess of £240,000



Hillside, Hoddesdon, EN11 8RW

**** VENDOR SUITED**** Westwood Leber are delighted to bring to the market this spacious and well-presented two-bedroom maisonette, set in a well-maintained development.

Offering bright and well-proportioned accommodation throughout, the property comprises a welcoming entrance hall leading into a generous living room, providing an excellent space for both relaxing and entertaining, with the added benefit of access onto a private balcony area. The separate kitchen is well arranged, offering ample storage and worktop space.

The property boasts two bedrooms, including a particularly large principal bedroom, both served by a well-appointed bathroom. Additional storage throughout the home enhances its practicality.

Externally, the property benefits from residents' parking along with its own garage en-bloc, providing excellent convenience and further storage options.

Further benefits include a remarkably long lease of approximately 956 years, making this an attractive long-term purchase.

Ideally located within easy reach of Hoddesdon town centre, with its range of shops, restaurants and transport links, this fantastic maisonette would make an ideal first-time purchase, investment opportunity or downsizing option. An internal viewing is highly recommended!



WESTWOODLEBER

WESTWOODLEBER
LET US GUIDE YOU HOME

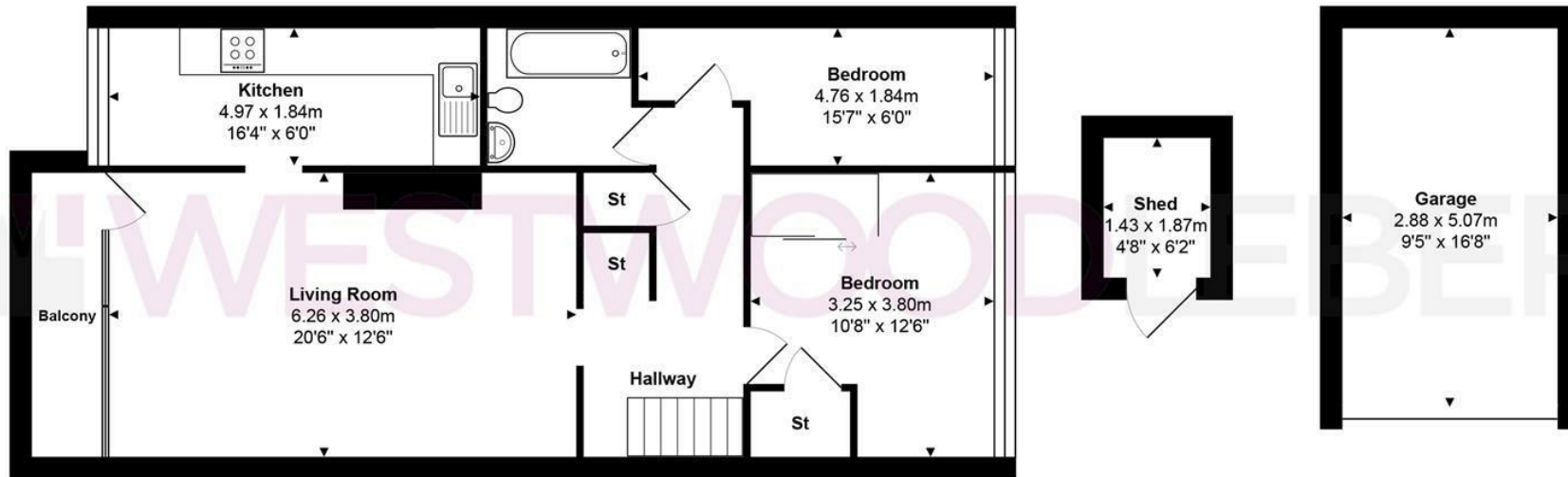

Total Area: approx. 89.2 m² ... 960 ft²

THE FLOORPLAN IS FOR ILLUSTRATIVE PURPOSES ONLY AND IS NOT TO SCALE.
 Measurements and features are approximate and may differ from the actual property. Verify all details independently; no liability is accepted for errors or omissions.

Property marketing provided by www.fotomarketing.co.uk











