



Dartnell Park Road, West Byfleet, KT14

Offers Over £1,372,000

🛏 5 🚿 2 🚗 5



NO CHAIN Completely remodelled and exquisitely refurbished around two years ago, this impressive detached family home offers between three and five bedrooms and approximately 3,462 square feet of spacious, adaptable accommodation. The layout is designed to suit a wide range of lifestyles, with five superb reception rooms providing excellent flexibility for everyday living, entertaining or working from home. The extensively equipped kitchen and breakfast room links neatly to the separate dining room via an internal door and a striking double sided log burner, creating a warm and inviting feel throughout these key spaces.

The principal bedroom is a genuine feature, presenting a magnificent vaulted ceiling, a Juliette balcony and a stylish Jack and Jill en suite bathroom. Every room has been finished with great care and attention to detail, reflecting the quality of the refurbishment.

The grounds have been beautifully landscaped, offering an attractive and well-planned setting for the house. A sweeping, newly installed driveway sits behind automated gates with an intercom entry system, giving both privacy and convenience.

The property is ideally positioned for West Byfleet, Weybridge and Woking mainline stations, all providing direct services to London Waterloo in around 30 minutes. Waitrose and a wide range of shops are also within easy reach. The A3 and the M25 at Junction 11 lie approximately three miles away, offering fast access to London, the south and major airports including Heathrow and Gatwick. The area is well served by an excellent choice of schools in both the private and state sectors.

Guildford, about eight miles to the south, provides a comprehensive mix of shopping, cafés, restaurants, theatre, a cinema complex, the Spectrum leisure centre and a mainline station. The wider area is known for its scenic walking and riding opportunities, and the RHS Gardens at Wisley are only three miles away. Golfers are particularly well catered for, with courses available at West Byfleet, Woodham, Pyrford, Wisley, St George's Hill, Burhill, Wentworth and Sunningdale.



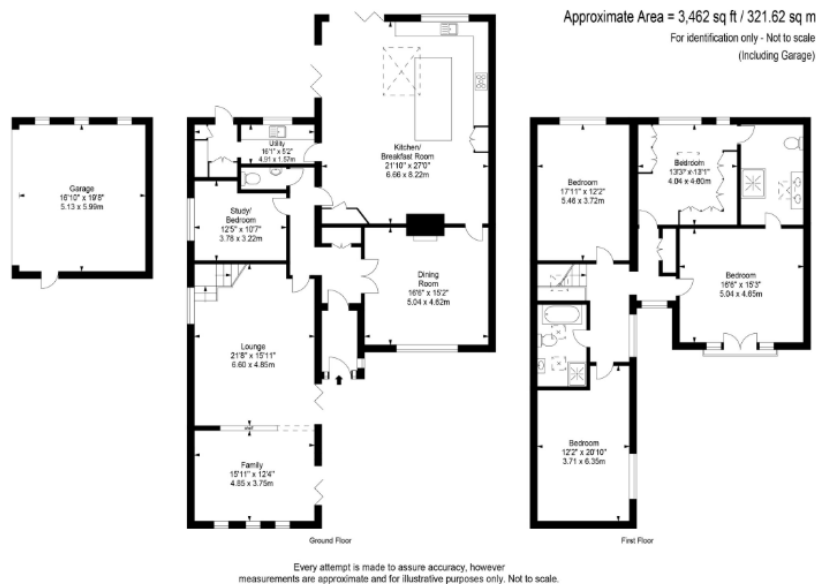

- Completely remodelled and exquisitely refurbished around two years ago.
- Four excellent reception rooms offering adaptable family and entertaining spaces.
- Stunning double sided log burner connecting the kitchen/breakfast room and dining room.
- Beautifully landscaped grounds providing an attractive and private setting.
- Excellent access to West Byfleet, Weybridge and Woking stations, A3 and M25.
- Approximately 3,462 sq ft of versatile living space with 3 to 5 bedroom flexibility.
- Extensively equipped kitchen and breakfast room linking to the dining room.
- Principal bedroom with vaulted ceiling, Juliette balcony and stylish Jack and Jilly beds.
- Newly installed sweeping driveway with automated gates and intercom entry system to highly regarded schools, RHS Wisley, golf courses and superb local amenities.

