



Gloucester Way, Thetford, IP24 1DL Offers In Excess Of £150,000

This former three bedroom end of terrace home, with potential to add your own stamp on, could make the ideal first time or investment purchase!

- SITUATED ON THE ABBEY DEVELOPMENT
- WALKING DISTANCE OF THETFORD RAILWAY STATION
- END TERRACED HOUSE
- DOWNSTAIRS CLOAKROOM
- LOW MAINTENANCE REAR GARDEN
- POTENTIAL TO ADD YOUR OWN STAMP
- CONVENIENT FOR TOWN ACCESS
- SPACIOUS ACCOMMODATION
- TWO BEDROOMS (FORMALLY THREE BEDROOMS)
- NO ONWARD CHAIN!



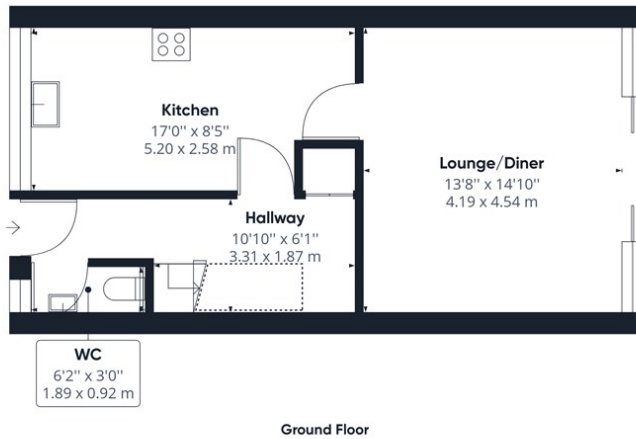

Ground Floor

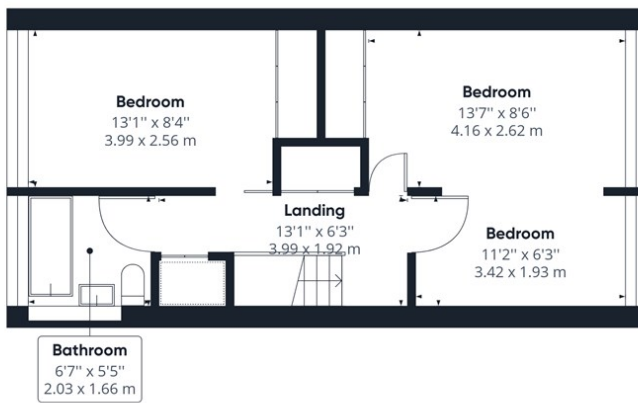

Floor 1

Approximate total area⁽¹⁾

900.73 ft²
83.68 m²

Reduced headroom

15.10 ft²
1.40 m²

(1) Excluding balconies and terraces

☒ Reduced headroom
(below 1.5m/4.92ft)

While every attempt has been made to ensure accuracy, all measurements are approximate, not to scale. This floor plan is for illustrative purposes only.

GIRAFFE360

