



**5 Chivers Road, Chippenham, SN15 3GN**

**£270,000**

Located on the popular development of Pewsham, a three bedroom end terrace house. The property is for sale with no onward chain and has accommodation briefly comprising: Entrance Hall, Cloakroom, Living Room, Conservatory, Three Bedrooms and En Suite, Bathroom. To the rear there is an enclosed garden with patio, gated access to the side with parking.

## Entrance Hallway



Front door leads into hallway.

## Cloakroom

W.C, hand basin, radiator

## Living Room 14'10" x 12'0" (4.52m x 3.66m)



Double glazed doors to conservatory, radiator.



## Conservatory 11'07" x 10'08" (3.53m x 3.25m)



Double glazed conservatory, door to garden.

## Modern Fitted Kitchen 11'1" x 8'07" (3.38m x 2.62m)



Double glazed window, work tops with a range of cupboards and drawers, inset ceramic sink unit, inset gas hob with cooker hood, electric oven, plumbing and space for washing machine, space for fridge/freezer, wall mounted gas boiler.

### **Landing**

Double glazed window, doors to bedrooms and bathroom.

### **Bedroom One 11'02" x 10'06" max (3.40m x 3.20m max)**



Double glazed window, radiator, door to en suite.

### **En Suite**

Double glazed window, en suite shower, hand basin, W.C, radiator.

### **Bedroom Two 8'07" x 7'01" (2.62m x 2.16m)**



Double glazed window, radiator.

### **Bedroom Three 9'04" x 5'11" (2.84m x 1.80m)**



Double glazed window, radiator.

### **Bathroom**

Panelled bath, hand basin, W.C, radiator.

### **Outside**



### **Rear**



To the rear there is an area of garden with patio

and shed. Gated side access to the parking spaces.

### **Front**



To the front there is an area of lawn.

### **Parking**



### **Tenure**

GOV.UK advise Freehold.

### **Council Tax Band**

Wiltshire Council advise Band C.

# Floor Plan

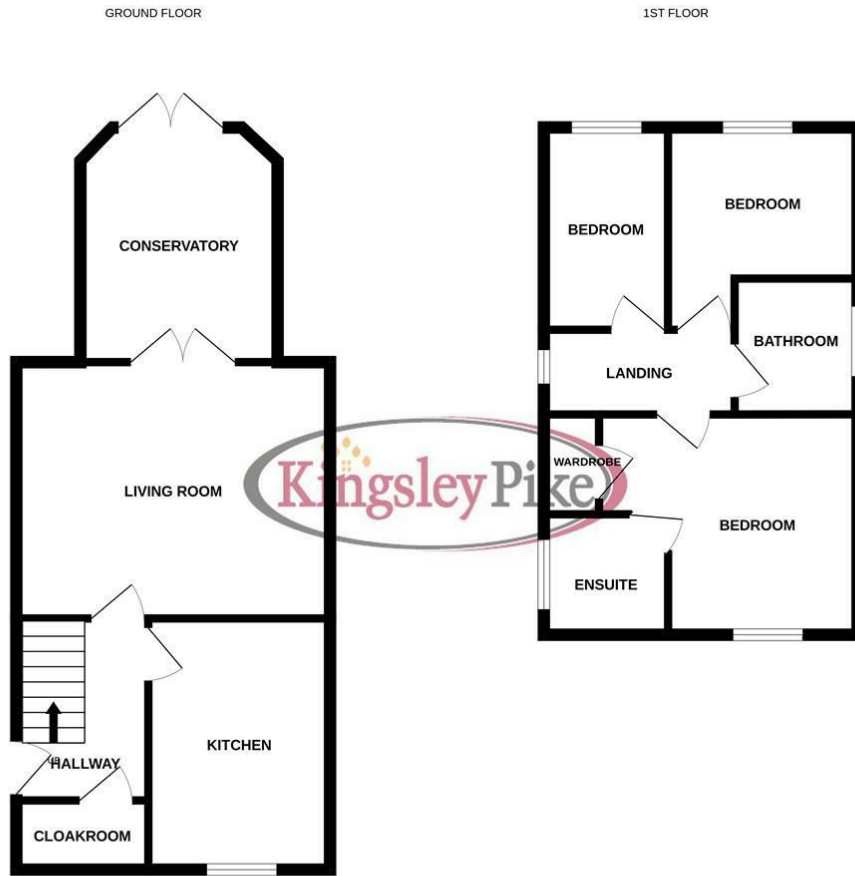

Whilst every attempt has been made to ensure the accuracy of the floorplans contained here, measurements of doors, windows, rooms and any other items are approximate and no responsibility is taken for any error, omission or mis-statement. This plan is for illustrative purposes only and should be used as such by any prospective purchaser. The services, systems and appliances shown have not been tested and no guarantee as to their operability or efficiency can be given.  
Made with Metropix ©2025

# Area Map



# Energy Efficiency Graph

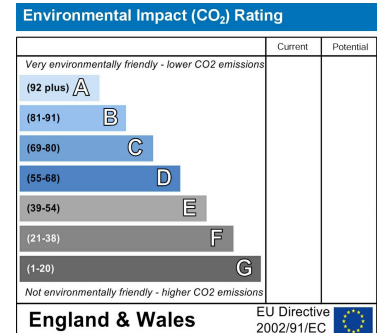
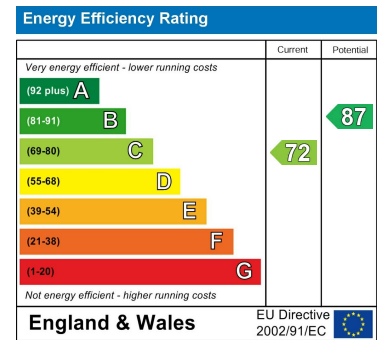

These particulars, whilst believed to be accurate are set out as a general outline only for guidance and do not constitute any part of an offer or contract. Intending purchasers should not rely on them as statements of representation of fact, but must satisfy themselves by inspection or otherwise as to their accuracy. No person in this firm's employment has the authority to make or give any representation or warranty in respect of the property.