



## Homevalley House

£75,000

- No onward Chain
- over 60's Only
- Communal Parking
- Communal Entertainment Room
- Council tax band B
- EPC Rating: C





## About the property

Home Valley House is situated on Bryngwyn Road between the Handpost and the city centre, within walking distance of bus stops, shops and a doctor's surgery. This popular development is perfect for anyone looking to move into assisted accommodation, with on-site management, a lift, and a pull-cord alarm in every flat.

This low-maintenance first-floor flat is located directly above the main entrance with a view of the garden. A hallway leads to a bathroom with walk-in shower and to a double-bedroom, and to a living room with adjoining fitted kitchen. There is a large store cupboard in the hallway housing a new boiler.

Communal facilities include a spacious lounge with daily activities for residents, a modern laundry room, well-maintained gardens, and a car park for residents and guests.

Call Peter Alan, Newport today to book your viewing!



## Accommodation

**Entrance Hallway**

**Living & Dining Area**

14' 9" x 10' 6" ( 4.50m x 3.20m )

**Kitchen**

7' 7" x 5' 7" ( 2.31m x 1.70m )

**Bedroom**

11' 6" x 8' 6" ( 3.51m x 2.59m )

**Shower Room**

6' 11" x 5' 3" ( 2.11m x 1.60m )

01633 221892

newport@peteralan.co.uk

## Floorplan

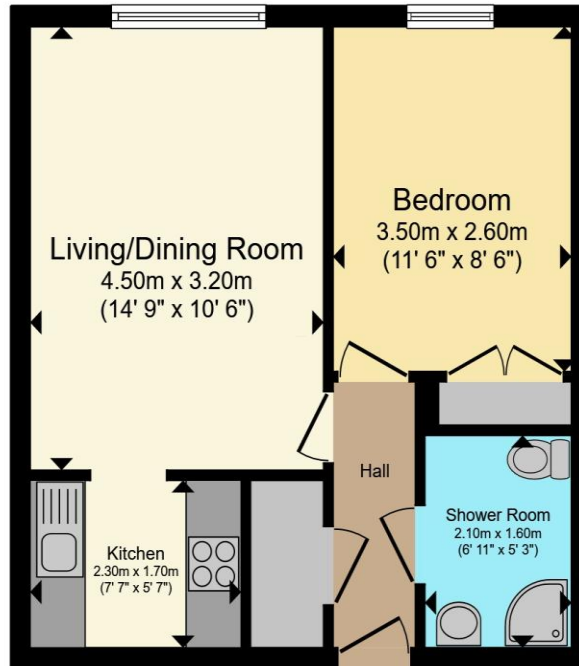

Total floor area 37.2 m<sup>2</sup> (400 sq.ft.) approx

This floor plan is for illustrative purposes only. It is not drawn to scale. Any measurements, floor areas (including any total floor area), openings and orientation are approximate. No details are guaranteed, they cannot be relied upon for any purpose and they do not form part of any agreement. No liability is taken for any error, omission or misstatement. A party must rely upon its own inspection(s). Powered by [www.propertybox.io](http://www.propertybox.io)



## Important Information

Note while we endeavour to make our sales details accurate and reliable, if there is any point which is of particular interest to you, please contact the office and we will be pleased to confirm the position for you. We have not personally tested any apparatus, equipment, fixtures, fittings or services and cannot verify they are in working order or fit for their purposes. Nothing in these particulars is intended to indicate that carpets or curtains, furnishings or fittings, electrical goods (whether wired or not). Gas fires or light fittings or any other fixtures not expressly included form part of the property offered for sale. This computer generated Floorplan, if applicable, is intended as a general guide to the layout and design of the property. It is not to scale and should not be relied upon for dimensions. Tenure: We cannot confirm the tenure of the property as we have not had access to the legal documents. The buyer is advised to obtain verification from their solicitor or surveyor.

Peter Alan Limited is registered in England and Wales under company number 2073153. Registered Office is Cumbria House, 16-20 Hockliffe Street, Leighton Buzzard, Bedfordshire, LU7 1GN. VAT Registration Number is 500 2481 05. For activities relating to regulated mortgages and non-investment insurance contracts, Peter Alan Limited is an appointed representative of Connells Limited which is authorised and regulated by the Financial Conduct Authority. Connells Limited's Financial Services Register number is 302221. Most buy-to-let

