

# GUILDHALL

SALES & LETTINGS



GUILDHALL  
SALES & LETTINGS

## 90 Longacre

Bamber Bridge, Preston, PR5 8HE

£125,000



Nestled in the charming area of Longacre, Bamber Bridge, this delightful house presents an excellent opportunity for investors seeking a promising addition to their portfolio. The property boasts three bedrooms, providing ample space for families or tenants alike. The well-proportioned bathroom ensures comfort and convenience for all residents.

The heart of the home is the inviting reception room, which seamlessly leads out to a lovely garden, perfect for outdoor relaxation or entertaining guests. This feature not only enhances the living space but also offers a wonderful connection to nature, making it an ideal spot for enjoying sunny days.

With its appealing layout and potential for rental income, this property is a fantastic choice for those looking to invest in a thriving community. Longacre is well-connected to local amenities and transport links, ensuring that residents can enjoy both the tranquility of suburban living and the convenience of nearby facilities. This house is a rare find and is sure to attract interest from discerning buyers. Don't miss the chance to explore this promising investment opportunity.



GUILDHALL  
SALES & LETTINGS

GUILDHALL  
SALES & LETTINGS

GUILDHALL  
SALES & LETTINGS

## Ground Floor

Entrance Vestibule 4'03 x 2'98 (1.30m x 0.61m)

WC 3'11 x 2'17 (1.19m x 0.61m)

Entrance Hallway 15 x 5'82 (4.57m x 1.52m)

Kitchen 13'3 x 12'4 (4.04m x 3.76m)

Living Room 19 x 10'9 (5.79m x 3.28m)

## First Floor

Bedroom One 12'11 x 12'7 (3.94m x 3.84m)

Bedroom Two 10'6 x 9'10 (3.20m x 3.00m)

Bedroom Three 9'6 x 7'8 (2.90m x 2.34m)

Bathroom 8'10 x 5'6 (2.69m x 1.68m)

## Area Map



## Floor Plans

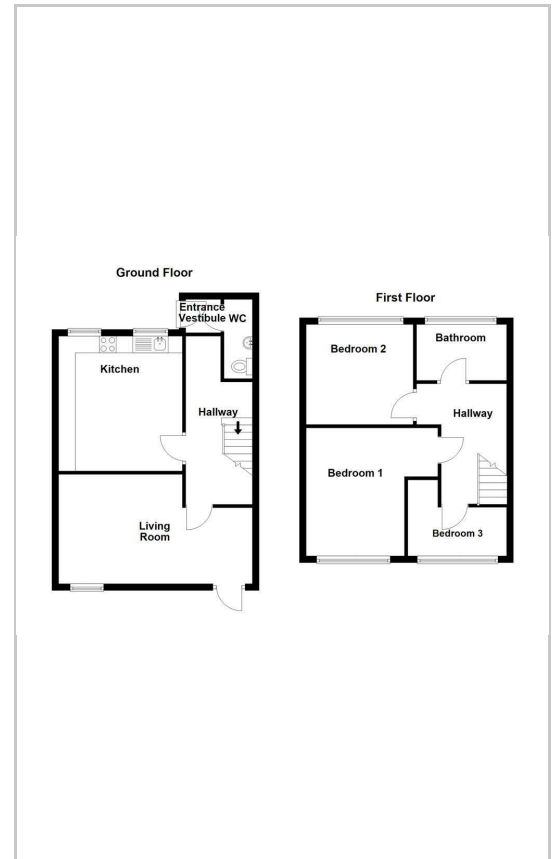

## Energy Efficiency Graph

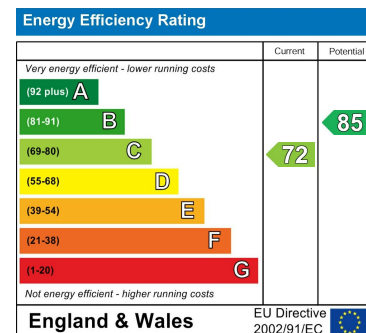

These particulars, whilst believed to be accurate are set out as a general outline only for guidance and do not constitute any part of an offer or contract. Intending purchasers should not rely on them as statements of representation of fact, but must satisfy themselves by inspection or otherwise as to their accuracy. No person in this firm's employment has the authority to make or give any representation or warranty in respect of the property.

441 Blackpool Road, Preston, PR2 2LE

Tel: 01772769999 Email: <https://guildhalllettings.co.uk/>