

## Charlotte Place, W1T

£550 Per week

A stylish, bright one double bedroom first floor apartment ideally located on this fashionable pedestrian street behind Charlotte Street and Goodge Street in the heart of Fitzrovia.

Charlotte Place is a vibrant and trendy pedestrianised street in the heart of fashionable Fitzrovia. The nearest Undergrounds are Goodge Street and Tottenham Court Road.

### Features

- One Double Bedroom
- Wood Floors
- Open Plan Kitchen
- Good Natural Light
- First Floor
- Great Location

# Charlotte Place, London, W1T

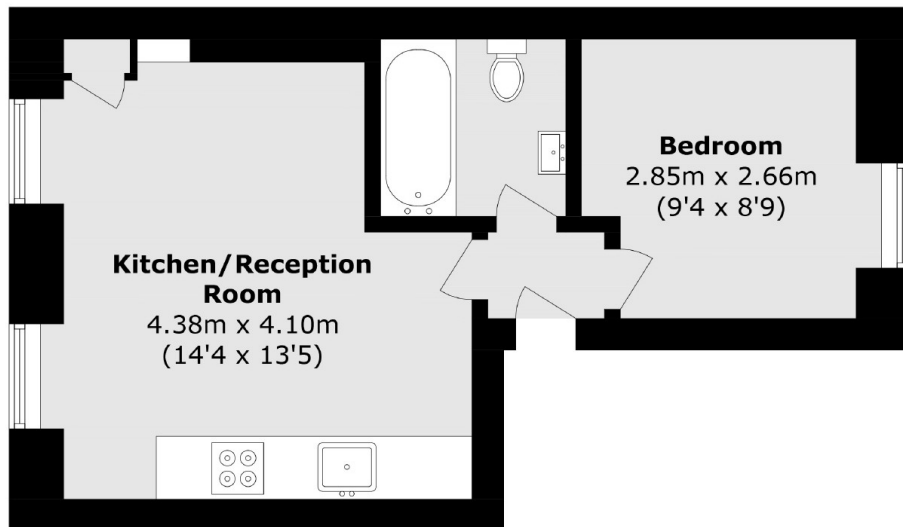

Total area (approx.): 28.3 sq. m (304.6 sq. ft)