

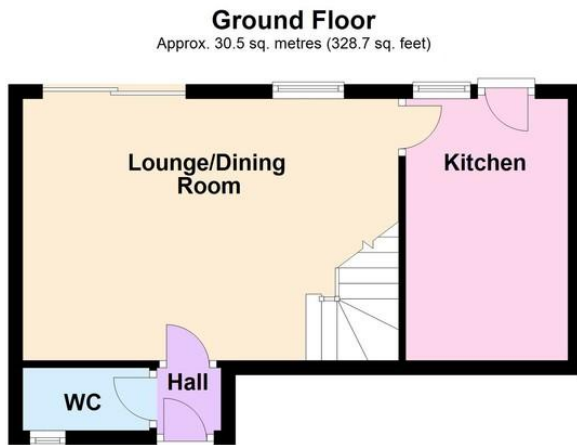

- 2 Bedroom House
- Gas Central Heating
- Double Glazing
- Parking & Garage
- Large Garden
- Available Late April
- Council Tax Band 'C'
- EPC Rating: - 'D'
- LIBRARY PHOTOS

21 Cypress Avenue, Worthing BN13 3PS  
**£1,350 pcm**



Total area: approx. 58.4 sq. metres (628.2 sq. feet)

A mid terrace two bedroom house with a garage and good size rear garden. The house is available to let from late April. Pets considered.

**ENTRANCE HALL**

**GROUND FLOOR CLOAKROOM**

**LOUNGE/DINING ROOM**  
17' 2" x 11' 10" (5.23m x 3.61m)

**KITCHEN**  
11' 11" x 7' 5" (3.63m x 2.26m)

**BEDROOM 1**  
12' x 8' 5" (3.66m x 2.57m)

**BEDROOM 2**  
11' 4" x 7' 6" (3.45m x 2.29m)

**BATHROOM/WC**

**GARAGE**

**PARKING SPACE**

**SOUTH REAR GARDEN**

The information and measurements contained within these details are for guidance only and do not form part of any contract.

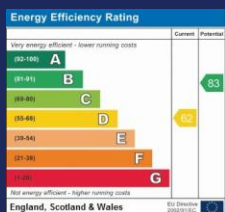

**90 THE STREET, RUSTINGTON, WEST SUSSEX, BN16 3NJ**

**lettings@hawkemetcalf.co.uk**

**www.hawkemetcalf.co.uk**

**01903 850450**