



**New Street, Ringwood, Hampshire**  
**Asking Price Of £199,950**

  
**MARTIN&CO**

- Well Presented 1 Bedroom Property
- Large Feature Fireplace
- Good Size Double Bedroom
- Outside Space
- Walking Distance To Ringwood
- Perfect Time House
- Potential Rental
- Lock Up & Leave
- No Onward Chain

Martin & Co Are Proud To Present this 1 Bedroom Characteristic Property Within Walking Distance Of Ringwood Town Centre.

You enter the property into the front aspect living room which has a stunning feature fireplace. The kitchen is to the rear with a range of units, a freestanding oven & under counter fridge. There is a door leading to the rear courtyard. To the first floor there is a good size bedroom with storage cupboard/wardrobe. The bathroom is to the rear with a shower over bath, WC and hand wash basin.

**Ground Floor**  
Approx. 17.7 sq. metres (190.6 sq. feet)

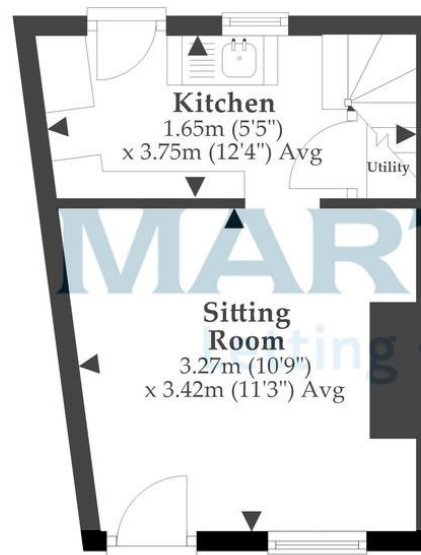

**First Floor**  
Approx. 17.7 sq. metres (190.6 sq. feet)

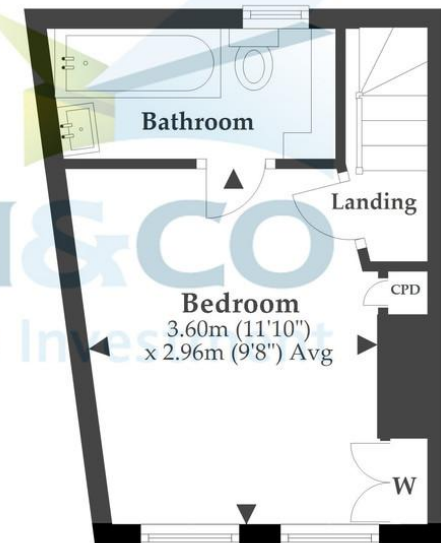

Total area: approx. 35.4 sq. metres (381.3 sq. feet)

This plan is not to scale and is for general guidance only. LJT Surveying Ltd Ringwood LJT SURVEYING

## Martin & Co Ringwood

42 High Street • Ringwood • BH24 1AG  
T: 01425 474005 • E: ringwood@martinco.com

**01425 474005**

<http://www.martinco.com>



**Accuracy:** References to the Tenure of a Property are based on information supplied by the Seller. The Agent has not had sight of the title documents. A Buyer is advised to obtain verification from their Solicitor. Items shown in photographs including but not limited to carpets, fixtures and fittings are not included unless specifically mentioned within the sales particulars. They may however be available by separate negotiation. Buyers must check the availability of any property and make an appointment to view before embarking on any journey to see a property. No person in the employment of the agent has any authority to make any representation about the property, and accordingly any information given is entirely without responsibility on the part of the agents, sellers(s) or lessors(s). Any property particulars are not an offer or contract, nor form part of one. **Sonic / Laser Tape:** Measurements taken using a sonic / laser tape measure may be subject to a small margin of error. **All Measurements:** All Measurements are Approximate. **Services Not tested:** The Agent has not tested any apparatus, equipment, fixtures and fittings or services and so cannot verify that they are in working order or fit for the purpose. A Buyer is advised to obtain verification from their Solicitor or Surveyor.