



## The Pantry St. Mary Street

, Chepstow, NP16 5EU

**£750**



## Description

Prime Town Centre location with easy pedestrian access to car parking and other amenities.

Chepstow Town itself hosts an impressive array of shops catering for all needs, along with a variety of Banks, Building Societies and a Post Office. Well known names such as Marks and Spencer, Greggs, Peacocks, Boots, WH Smith, SuperDrug along with various coffee shops and restaurants are prominent. The town centre also has a great variety of successful independent retailers.

The unit is located on the popular and attractive St Marys Street, offering high volumes of passing potential customers.

Charges and Fees - The prospective tenant will be responsible for contribution towards legal costs for preparation of agreements etc.

Size - Approx 48 Sq M. / 516 Sq Ft.

Rent - £795 per month

A deposit will be required which is typically equivalent to two months rent.

Available - Now

Viewing Strictly by Appointment Only via Moon & Co

## Accommodation

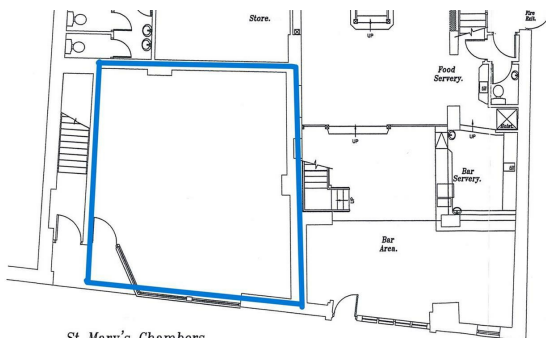

St Mary's Chambers  
Ground Floor Plan.

The Lime Tree