

MARTYN COX
— & COMPANY —



Pine Rise, Witney – OX28

Guide Price £364,950

Pine Rise

Witney,

A modern three bedroom house in Madley Park with rear garden, garage and parking. Available with no onward chain.

Council Tax band: C

Tenure: Freehold

- Three bedroom family home
- Close to Madley Park shops and schooling
- Available with no onward chain
- Sitting/dining room & kitchen
- Cloakroom & two shower rooms
- Garden with garage & parking space at rear





Pine Rise Floor Plan

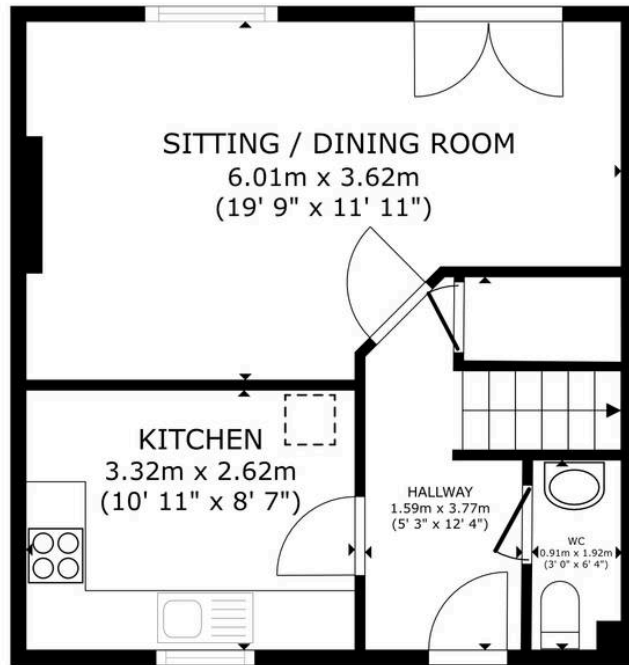

FLOOR 1

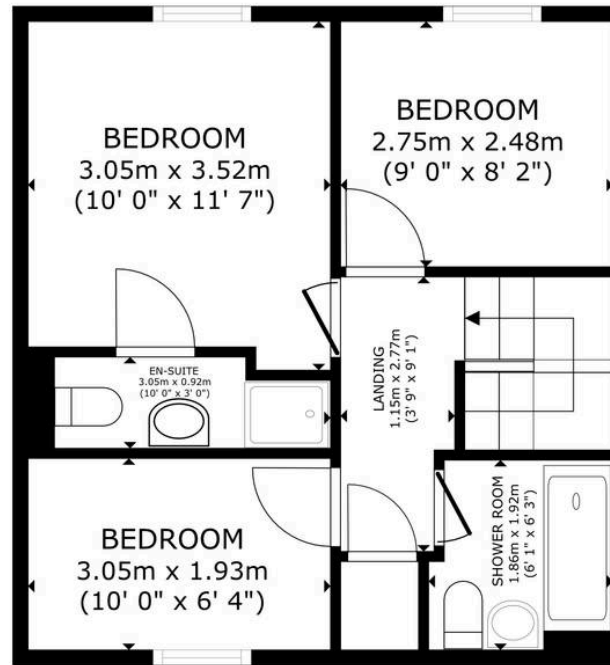

FLOOR 2

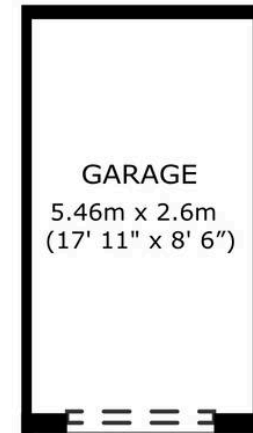

GROSS INTERNAL AREA (EXCLUDING GARAGE)
FLOOR 1 38.1 m² (410 sq.ft.) FLOOR 2 37.5 m² (403 sq.ft.)
TOTAL : 75.6 m² (813 sq.ft.)
SIZES AND DIMENSIONS ARE APPROXIMATE, ACTUAL MAY VARY.

Martyn Cox & Company

6-8 Corn Street, Witney - OX28 6BL

01993 779020 • property@martyncox.com • www.martyncox.com



These particulars are approximate and for illustrative purposes only. They have been prepared in good faith and not intended to be part of an offer or contract. We have not carried out a structural survey and the services, appliances and fittings have not been tested. photos, measurements, floor plans, distances, lease details, services charges and ground rent are given as a guide only.