



**Price**

**£50,000**

**Leasehold**

1x  1x  1x 

**Knowle Lodge, Croydon  
Road, Caterham, Surrey,  
CR3**

**cubitt&west**  
Helping you move forwards



## Main features

- Well maintained communal gardens
- Great communal areas including lounge, conservatory, laundry room, library and guest suite
- Lift serviced and residents parking
- Available with no onward chain

## Accommodation

### GROUND FLOOR

Entrance Hallway

Lounge: 15'5 x 10'3 (4.70m x 3.13m)

Kitchen: 6'7 x 6'6 (2.01m x 1.98m)

Bedroom : 12'3 x 8'7 (3.74m x 2.62m)

Bathroom: 7'7 x 5'5 (2.31m x 1.65m)

### OUTSIDE

Communal Garden

Off Street Parking

## Ground Floor

Approx. 42.1 sq. metres (453.1 sq. feet)

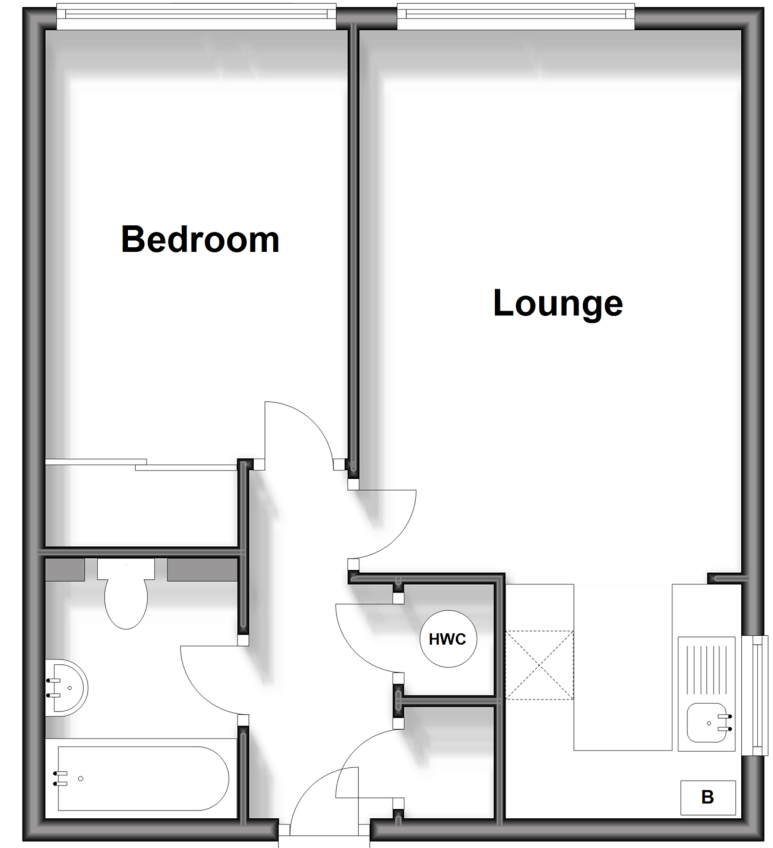

**Call Caterham - 01883 331000 ■ [cubittandwest.co.uk](http://cubittandwest.co.uk)**

- Legal advice should be taken to verify fixtures/fittings, planning, alterations and/or lease details
- Appliances & services are untested, dimensions are approximate and floor plans are not to scale



24407878/20250109/LP/BG