



**HENDERSON  
CONNELLAN**  
ESTATE AGENTS



## Hurlingham Road, Market Harborough

£1,350PCM (Deposit: £1,557)

🛏 4 🍳 2 🛋 1



- Established residential location within walking distance of the town centre
- Kitchen/Dining Room
- Living Room
- Four Bedrooms
- Main Bedroom with En Suite
- Garage
- South Facing Garden

Tax Band: F Furnished: Not Specified

### "Family Favourite"

Situated in an established residential location within walking distance of the town centre, this impressive semi-detached property boasts four bedrooms, a south facing garden, off road parking and a garage!

Conveniently located within walking distance to the town centre, leisure centre, local primary and secondary schools, supermarkets and the train station with links to London St Pancras within an hour.

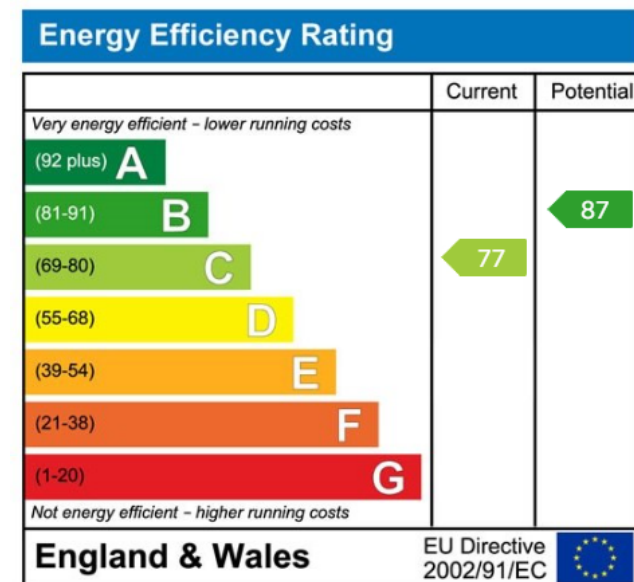
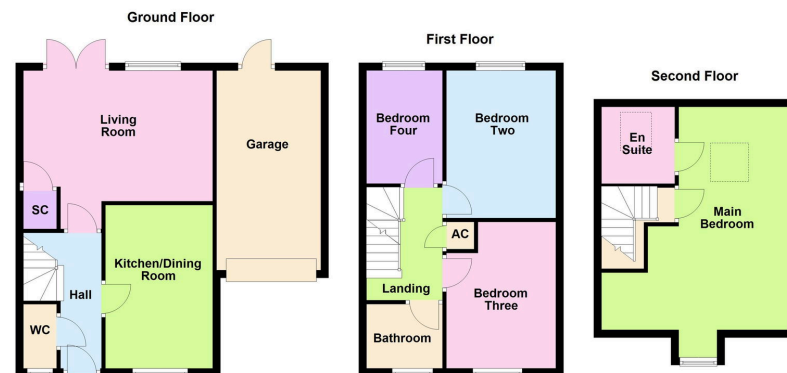

63 High Street, Market Harborough,  
Leicestershire, LE16 7AF

Disclaimer: These particulars do not form part of any offer or contract and should not be relied upon as statements or representations of fact. Any areas, measurements of distances are approximate. The text, photographs and plans are for guidance only and are not necessarily comprehensive.

