



**HENDERSON
CONNELLAN**
ESTATE AGENTS

Silver Street, Broughton, NN14

"Easy Living"

2 2 0



"Easy Living"

This fabulous, detached dormer bungalow is situated in the heart of Broughton which enjoys a pub, villages store, newsagents/post office, parkland, and rural walks as well as offering convenient access to Kettering, Wellingborough and Northampton.

The versatile interior includes an entrance vestibule leading to the entrance hall, living room with views over the garden, a generous kitchen/dining room and sunroom. There is a double bedroom and shower room to the ground floor and two further double bedrooms one with an en suite to the first floor. Outside the generous plot features a walled fore garden and good size, enclosed rear garden with parking and three garages to the back. Village living with the added advantage of amenities.

Kitchen/Dining Room - 2.01m x 5.97m (6'7" x 19'7")

Living Room - 5.54m x 3.58m (18'2" x 11'9")

Sun Room - 1.75m x 3.58m (5'9" x 11'9")

Bedroom 1 - 3.66m x 3.63m (12'0" x 11'11")

Bathroom - 2.97m x 2.64m (9'9" x 8'8")

Bedroom 2 - 3.66m x 4.39m (12'0" x 14'5")

Bedroom 3 - 3.3m x 3.07m (10'10" x 10'1")

Ensuite - 2.97m x 1.4m (9'9" x 4'7")



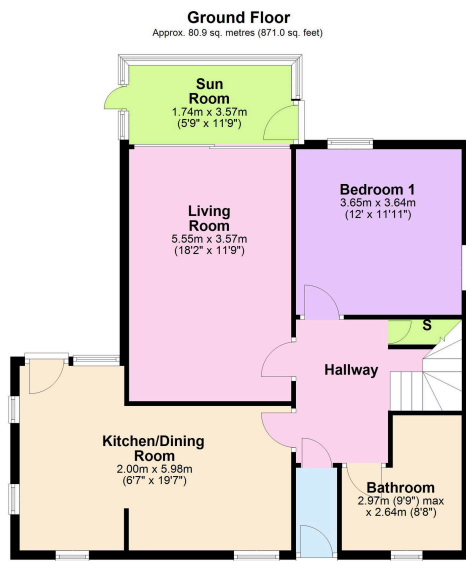

Total area: approx. 120.4 sq. metres (1295.4 sq. feet)

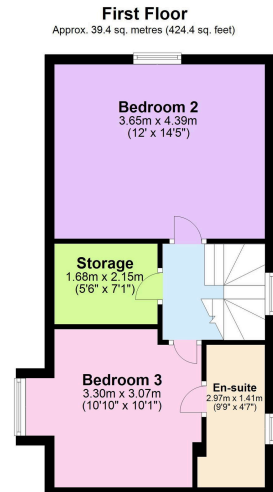

- Gas Central Heating
- Mostly Sealed Unit Double Glazed Windows
- Dormer Bungalow
- Three Double Bedrooms
- Kitchen/ Dining Room
- Tripple Garage
- Village Location
- EPC RATING: C
- COUNCIL TAX: D



Disclaimer: These particulars do not form part of any offer or contract and should not be relied upon as statements or representations of fact. Any areas, measurements of distances are approximate. The text, photographs and plans are for guidance only and are not necessarily comprehensive.

15-16 Market Place, Kettering,
Northamptonshire, NN16 0AJ

