





## Bath Road, Kettering NN16

"Ground Floor Apartment With Garden"

1 1 1





### "Ground Floor Apartment With Garden"

This ground floor apartment offers living all on one level and benefits from its very own garden. Situated a moment from the park, with lovely walks, the town centre and a wealth of amenities are within easy reach. The interior benefits from gas central heating and UPVC double glazing to include a free flowing kitchen with integrated oven and hob which opens to a dining and living area with attractive feature fireplace and double doors directly to the garden area. There is a double sized bedroom with built in wardrobes and a principal bathroom. Outside the garden area is arranged with easy care in mind ideal for a seating area and a block paved area has allocated parking for one car. Easy, convenient living !

**Living Room/Diner/Kitchen** - 5.64m x 4.14m (18'6" x 13'7")

**Bedroom** - 3.15m x 2.97m (10'4" x 9'9")

**Bathroom** - 2.92m x 1.57m (9'7" x 5'2")



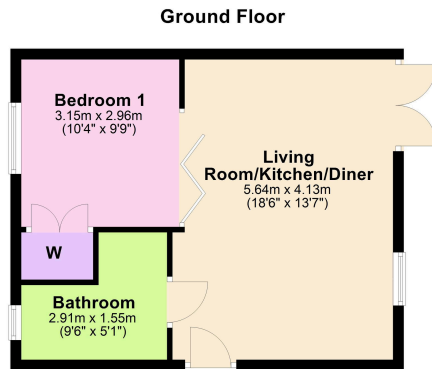

- Gas Central Heating
- UPVC Double Glazing
- Ground floor
- Free flowing Kitchen/Dining/Living Room
- Double Bedrooms
- Private Allocated Parking
- LEASE - 999 Years as of 2024
- SERVICE CHARGE - £75.00 PCM
- EPC RATING: PENDING
- COUNCIL TAX: A



Disclaimer: These particulars do not form part of any offer or contract and should not be relied upon as statements or representations of fact. Any areas, measurements of distances are approximate. The text, photographs and plans are for guidance only and are not necessarily comprehensive.

15-16 Market Place, Kettering,  
Northamptonshire, NN16 0AJ

