



**HENDERSON  
CONNELLAN**  
ESTATE AGENTS

Thurston Drive, Kettering  
£1,195PCM (Deposit: £1,195)

3 1 1



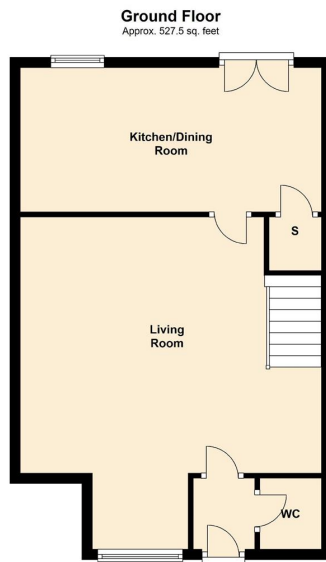

Tax Band: Furnished: Not specified

Leisurely living on the KLV! This three bedroomed end mews residence offers quality and design that will be hard to beat. Situated on the ever popular Kettering Leisure Village it offers great access for the A14, mainline railway and within easy walking distance of the town centre. The accommodation benefits from gas central heating and UPVC double glazing throughout and the well equipped kitchen features a washing machine, dryer, tall freestanding fridge freezer and a 4-ring burner oven. Upstairs there are two double bedrooms with fitted wardrobes and a third single bedroom / study as well as a family bathroom. The rear garden is part paved and laid to lawn with a timber fence surround, offering perfect entertaining space for those long summer nights! Call in today as high demand is expected.

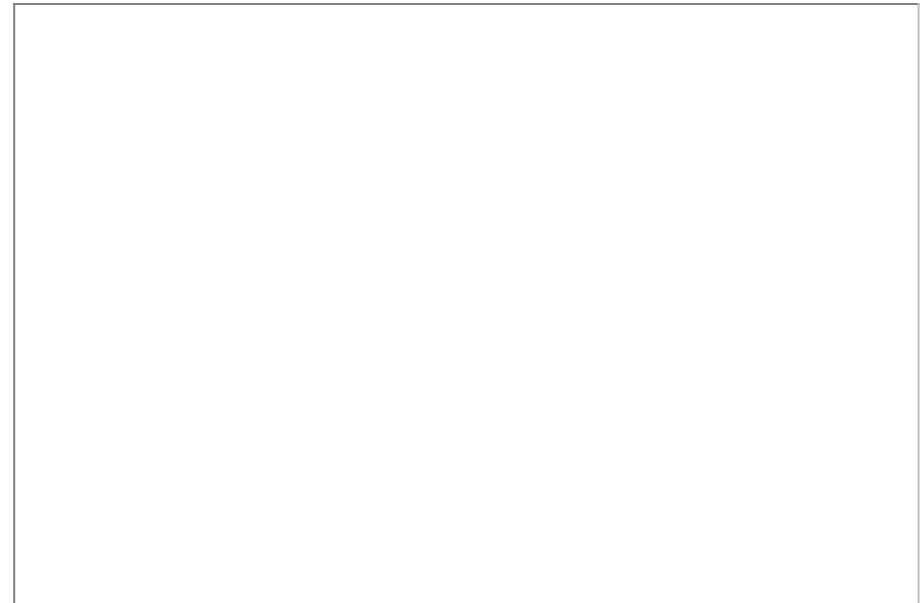

15-16 Market Place, Kettering, Northamptonshire, NN16 0AJ

