



**HENDERSON  
CONNELLAN**  
ESTATE AGENTS

# Pollard Street, Kettering NN16

"A Stylish Habitat"

🛏️ 2 🪑 1 🚗 1



## "A Stylish Habitat"

This red brick Victorian town house has a fusion of period and contemporary styling. Offering an impressive interior which has been well cared for by the present owners, expect to see a feature fireplace with the warmth of a working fire in the living room which flows to a dining room and onto the designer Kitchen with integrated oven and hob. Upstairs are two double bedrooms and a stunning cool white bathroom. The rear garden is a great size with timber decked area, lawn and plantings as well as a brick built outbuilding. Set in this highly sought after residential area, a moments' walk from Rockingham Pleasure Park as well as the town centre, schools and a wealth of amenities. If you are looking for a mature property with an up to date interior. Call 01536 417888.

**Living Room** - 3.63m x 3.43m (11'11" x 11'3")

**Dining Room** - 3.63m x 3.43m (11'11" x 11'3")

**Kitchen** - 4.09m x 2.44m (13'5" x 8'0")

**Bedroom One** - 4.44m x 3.63m (14'7" x 11'11")

**Bedroom Two** - 3.63m x 2.72m (11'11" x 8'11")

**Bathroom** - 2.95m x 2.34m (9'8" x 7'8")



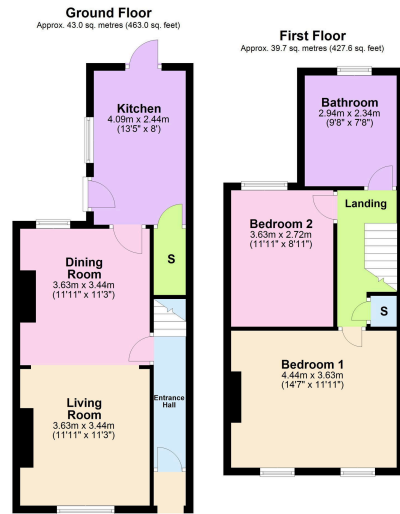

Total area: approx. 82.7 sq. metres (890.6 sq. feet)

- Terraced Property
- Two Bedrooms
- Two Reception Rooms
- Gas Central Heating
- COUNCIL TAX: A
- EPC RATING: D



Disclaimer: These particulars do not form part of any offer or contract and should not be relied upon as statements or representations of fact. Any areas, measurements of distances are approximate. The text, photographs and plans are for guidance only and are not necessarily comprehensive.

15-16 Market Place, Kettering,  
Northamptonshire, NN16 0AJ

