



Old Road, Walgrave NN6

"Creative Character"

3 1 1



"Creative Character"

Situated in the beautiful Northamptonshire village of Walgrave, this fabulous three bedroom mid-mews cottage has been creatively and extensively updated and improved. The stylish interior includes a generous entrance hall with access to the guest cloakroom, flowing through to the open plan designer kitchen/dining room which has been fitted with dark shaker cupboards fused with oak worksurfaces and complimented by select integrated appliances. French doors open out from the dining area to the wonderful cottage garden, and the cosy living room enjoys the warmth of a wood burning stove. Upstairs, expect to find three good sized double bedrooms, and a sumptuous bathroom with separate double sized shower enclosure. Outside, the cottage enjoys a charming and idyllic rear garden with various brick outbuildings. A pub, primary school, picturesque church and fine rural walks can all be enjoyed within the village.

Living Room - 3.48m x 3.15m (11'5" x 10'4")

Kitchen/Dining Room - 6.98m x 2.79m (22'11" x 9'2")

Bedroom One - 4.11m x 2.46m (13'6" x 8'1")

Bedroom Two - 3.45m x 3.15m (11'4" x 10'4")

Bedroom Three - 3.53m x 2.79m (11'7" x 9'2")

Bathroom - 3.4m x 1.8m (11'2" x 5'11")



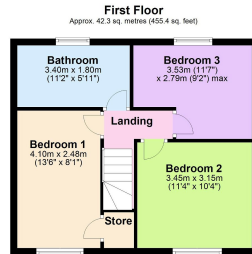
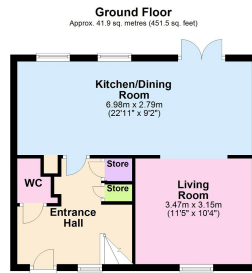

Total area: approx. 84.3 sq. metres (906.9 sq. feet)

- Cottage
- Guest Cloakroom
- Mature Rear Garden
- EPC RATING: C
- Village Location
- Three Double Bedrooms
- COUNCIL TAX: A



Disclaimer: These particulars do not form part of any offer or contract and should not be relied upon as statements or representations of fact. Any areas, measurements of distances are approximate. The text, photographs and plans are for guidance only and are not necessarily comprehensive.

15-16 Market Place, Kettering,
Northamptonshire, NN16 0AJ

