



**HENDERSON  
CONNELLAN**  
ESTATE AGENTS

# Alexandra Street, Burton Latimer NN15

"Alexandra The Great"

🛏️ 2 🪑 1 🛋️ 2



## "Alexandra The Great"

Looks can be deceptive, and that is certainly the case with the generous, Victorian bay fronted town house situated within easy reach of the heart of Burton Latimer with shops, doctors, restaurants and a wealth of amenities. The interior benefits from gas central heating and UPVC double glazing to include an entrance hall, living room with bay window and feature fireplace, separate dining room, fitted kitchen, utility room and guest cloakroom. Upstairs there are two double bedrooms both with period fireplaces and a principal bathroom. Outside the rear garden is huge with a patio and decked area. Come and see for yourself!

**Living Room** - 3.94m x 3.33m (12'11" x 10'11")

**Dining Room** - 3.68m x 3.61m (12'1" x 11'10")

**Kitchen** - 3.3m x 1.98m (10'10" x 6'6")

**Bedroom 1** - 4.22m x 3.33m (13'10" x 10'11")

**Bedroom 2** - 3.61m x 3.3m (11'10" x 10'10")

**Bathroom** - 3.23m x 1.93m (10'7" x 6'4")



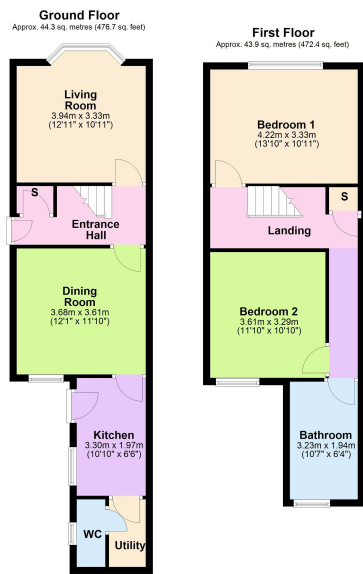

Total area: approx. 88.2 sq. metres (949.1 sq. feet)

- Terraced House
- Two Bedrooms
- Two Reception Rooms
- Mains Gas, Water and Electric
- Council Tax: A
- EPC Rating: D



15-16 Market Place, Kettering,  
Northamptonshire, NN16 0AJ

Disclaimer: These particulars do not form part of any offer or contract and should not be relied upon as statements or representations of fact. Any areas, measurements of distances are approximate. The text, photographs and plans are for guidance only and are not necessarily comprehensive.

