



**HENDERSON
CONNELLAN**
ESTATE AGENTS

Spencer Street, Burton Latimer NN15

"Impressive Proportions"

🛏️ 2 🪑 1 🚗 2



"Impressive Proportions"

Both inside and out! This deceptively large two-bedroom terraced property is located in the heart of Burton Latimer, only a short walk from the town centre, Restaurants and a wealth of amenities. The mainline railway station with access to London St Pancras in under an hour and Kettering town centre are also just a short distance away. The well-presented interior benefits from gas central heating and UPVC double glazed windows to include an entrance hall, generous living with bay window, separate formal dining room and kitchen. Upstairs there are two generous double bedrooms and a well-appointed principal bathroom complete with separate shower enclosure. Outside the gardens are beautifully kept. Exceptional!

Living Room - 3.3m x 3.18m (10'10" x 10'5")

Dining Room - 4.19m x 3.3m (13'9" x 10'10")

Kitchen - 3.96m x 2.41m (13'0" x 7'11")

Bedroom 1 - 4.22m x 3.28m (13'10" x 10'9")

Bedroom 2 - 3.33m x 2.62m (10'11" x 8'7")

Bathroom - 3.91m x 2.36m (12'10" x 7'9")



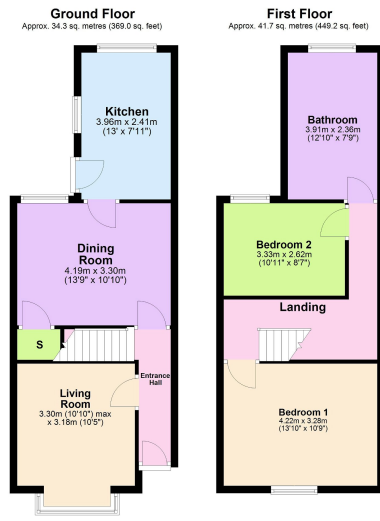

Total area: approx. 76.0 sq. metres (818.2 sq. feet)

- Terraced House
- Close To Amenities
- Council Tax: A
- Two Bedrooms
- UPVC Windows
- EPC RATING: PENDING



Disclaimer: These particulars do not form part of any offer or contract and should not be relied upon as statements or representations of fact. Any areas, measurements of distances are approximate. The text, photographs and plans are for guidance only and are not necessarily comprehensive.

15-16 Market Place, Kettering,
Northamptonshire, NN16 0AJ

