



**HENDERSON
CONNELLAN**
ESTATE AGENTS

Sanderson Close, Kettering NN15

"A Champion Among Athletes"

🛏️ 2 🪑 1 🚿 2



"A Champion Among Athletes"

This fabulous two bedroom semi detached home enjoys a fabulous plot with private driveway, single garage and well kept front and rear gardens, within the highly sought after Kettering Leisure village. The interior benefits from gas central heating and UPVC double glazed windows to include an entrance hall, kitchen with integrated oven and hob and a good size living room offering living and dining options with patio doors to the garden. Upstairs there is a bathroom and two double bedrooms. The town centre, mainline railway and a wealth of amenities are within easy reach. This home is currently tenanted, the tenants are keen to remain should an investor buyer be interested.

Living Room - 4.32m x 3.61m (14'2" x 11'10")

Kitchen - 2.97m x 2.29m (9'9" x 7'6")

Bedroom One - 3.58m x 2.69m (11'9" x 8'10")

Bedroom Two - 3.61m x 2.54m (11'10" x 8'4")

Bathroom - 1.91m x 1.7m (6'3" x 5'7")



- End Of Mews House
- Two Bedrooms
- Parking and Single Garage
- Investment
- Tenant in Occupation
- Gas Central Heating
- EPC RATING: C
- COUNCIL TAX: B

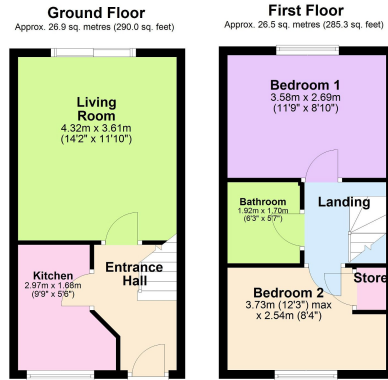

Total area: approx. 53.5 sq. metres (575.4 sq. feet)



Disclaimer: These particulars do not form part of any offer or contract and should not be relied upon as statements or representations of fact. Any areas, measurements of distances are approximate. The text, photographs and plans are for guidance only and are not necessarily comprehensive.

15-16 Market Place, Kettering,
Northamptonshire, NN16 0AJ

