



**HENDERSON
CONNELLAN**
ESTATE AGENTS

Lyveden Road, Brigstock NN14 3HE

"Chef Wanted for Great Kitchen"

🛏️ 3 🚿 2 🚪 2



"Chef Wanted for Great Kitchen"

The stunning designer kitchen/breakfast room is the perfect social space with oak worksurfaces, integrated appliances and central island ideal for seating social gatherings! The deceptively large detached home offers lateral living in the heart of Brigstock with shops, pub, post office, primary school and lovely rural walks. The stylish interior includes an entrance hall, living room with feature fireplace and working fire, the exceptional kitchen and adjoining utility room. There is a principal bathroom and three double bedrooms, the master with en suite and fitted wardrobes, the guest also with built in wardrobes. Gas central heating and UPVC double glazing complete the inside. Outside the foregarden is set behind established hedging with lawned frontage and driveway with parking for two/three cars leading to a single garage and rear garden is arranged with easy care in mind. A recipe for success.

Living Room - 4.78m x 4.09m (15'8" x 13'5")

Kitchen/Breakfast Room - 4.8m x 4.06m (15'9" x 13'4")

Conservatory - 4.09m x 2.92m (13'5" x 9'7")

Utility Room - 2.44m x 2.06m (8'0" x 6'9")

Bedroom 1 - 4.11m x 2.87m (13'6" x 9'5")

Ensuite - 2.92m x 0.84m (9'7" x 2'9")

Bedroom 2 - 2.97m x 2.01m (9'9" x 6'7")

Bedroom 3 - 2.92m x 2.9m (9'7" x 9'6")

Bathroom - 3.2m x 2.06m (10'6" x 6'9")



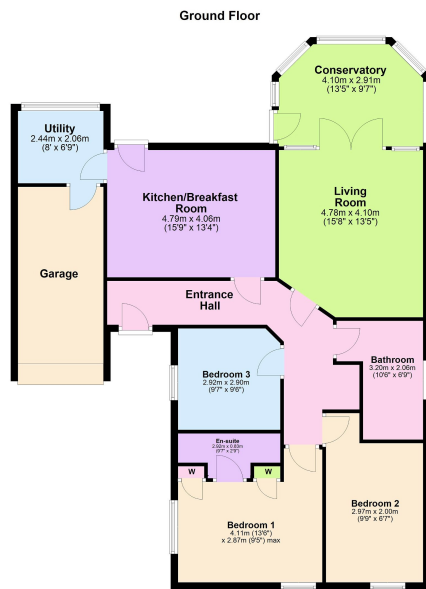

- Village Living!
- Three Bedrooms
- Designer Kitchen/ Breakfast Room
- Driveway Parking
- EPC RATING: D
- Detached Bungalow
- Bathroom and Ensuite
- Garage
- Lovely rear Garden
- COUNCIL TAX: E



15-16 Market Place, Kettering,
Northamptonshire, NN16 0AJ

Disclaimer: These particulars do not form part of any offer or contract and should not be relied upon as statements or representations of fact. Any areas, measurements of distances are approximate. The text, photographs and plans are for guidance only and are not necessarily comprehensive.

