

## Russell Street, Kettering NN16 0EL

£130,000

🛏 2 🚗 1 🚲 1



### "Urban Living"

This established first floor apartment is situated within easy reach of the Restaurant/Cultural Quarter, the town centre and mainline railway connecting to St Pancras in under an hour. The interior includes an entrance hall, living/dining room, kitchen with integrated oven and hob, two well-proportioned bedrooms and a modern principal bathroom. The apartment enjoys a security entry phone system and off road parking for one car in the parking quadrant to the back. Ultra convenient Urban Living!



15-16 Market Place, Kettering, Northamptonshire, NN16 0AJ



## Key Features

- First Floor Apartment
- Entry Security Phone Systems
- No Chain
- Council Tax: A
- Service charge: £1010.00pa
- Two Bedrooms
- Parking For One Car
- EPC Rating: C
- Lease 999 years from October 1989
- Share of Freehold

## First Floor Flat

Approx. 49.0 sq. metres (527.6 sq. feet)

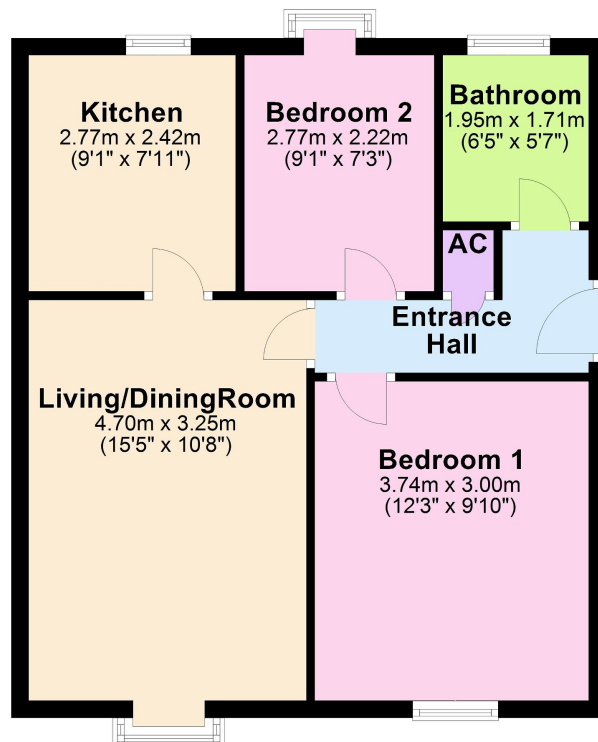

Total area: approx. 49.0 sq. metres (527.6 sq. feet)



15-16 Market Place, Kettering, Northamptonshire, NN16 0AJ