



Pavillion Court, Kettering

"Lateral Living"

 2  2  1



"Lateral Living"

A wonderful ground floor apartment which enjoys a substantial interior all on one level, as well as it's OWN PRIVATE GARDEN. The high specification design and finish with a palatial free flowing kitchen/dining/living room, double doors leading to the garden. There are two double bedrooms, the master with en-suite and the guest bedroom with exclusive use of the bathroom. There is a security entry system and gas central heating as well as allocated parking and it's own private garden with patio and lawn. Interior imagery has been digitally enhanced and may differ to specification.

Key Features

- Grade II Listed
- High Specification
- Wonderful Commual Gardens
- Garden
- EPC RATING: PENDING
- Ground Floor Apartment
- Two Bedrooms
- Parking
- En suite
- COUNCIL TAX: PENDING

Ground Floor

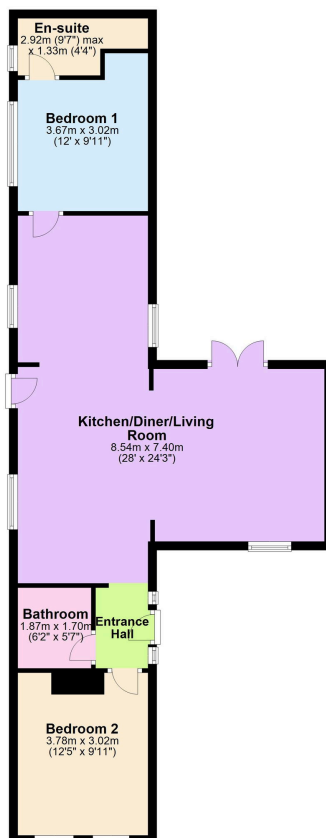

Total area: approx. 73.5 sq. metres (791.5 sq. feet)



15-16 Market Place, Kettering, Northamptonshire, NN16 0AJ

