

Hall Lane, Kettering

"Lateral Living"

🛏 2 🚿 2 🚗 1



"Lateral Living"

A wonderful ground floor apartment which enjoys a substantial interior all on one level, as well as it's own private garden. The high specification design and finish with a palatial free flowing kitchen/dining/living room, double doors leading to the garden. There are two double bedrooms, the master with en-suite and the guest bedroom with exclusive use of the bathroom. There is a security entry system and gas central heating as well as allocated parking. The property enjoys it's own private garden with patio seating area and has been beautifully landscaped.



15-16 Market Place, Kettering, Northamptonshire, NN16 0AJ



Key Features

- Grade II Listed
- High Specification
- Wonderful Commual Gardens
- Garden
- EPC RATING: PENDING
- Ground Floor Apartment
- Two Bedrooms
- Parking
- En suite
- COUNCIL TAX: PENDING

Ground Floor

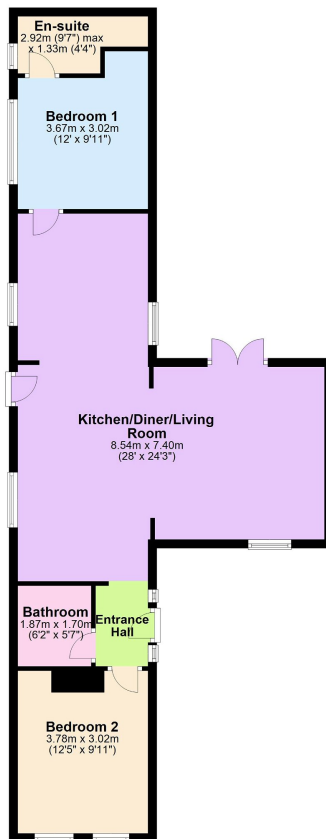

Total area: approx. 73.5 sq. metres (791.5 sq. feet)

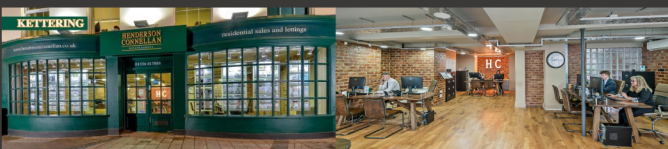

15-16 Market Place, Kettering, Northamptonshire, NN16 0AJ

