

Cleaver Court, Station Road Kettering

£70,000

 1  1  1



"Affordable Level Living..."

Accessed via either stairs or a lift, this top floor apartment enjoys tree and roof top views, the town centre, Restaurant/cultural quarter and mainline railway are a short walk away. Specifically for the over 60's, this scheme managed apartment enjoys 24 hour monitoring with a pull cord to each room providing peace of mind, there is also a communal residents lounge with various events. The light filled accommodation benefits from electric heating and UPVC double glazing to include an entrance hall, generously sized living/ dining room, fitted kitchen, double sized bedroom and a principal bathroom. Convenient, secure living. EPC RATING: C COUNCIL TAX: B

Key Features

- Top Floor Retirement Apartment
- No Chain
- Security Entrance
- Communal Parking
-
- One Bedroom
- Communal Residents Lounge
- Electric Heating
- Share of Freehold
-

Top Floor Apartment

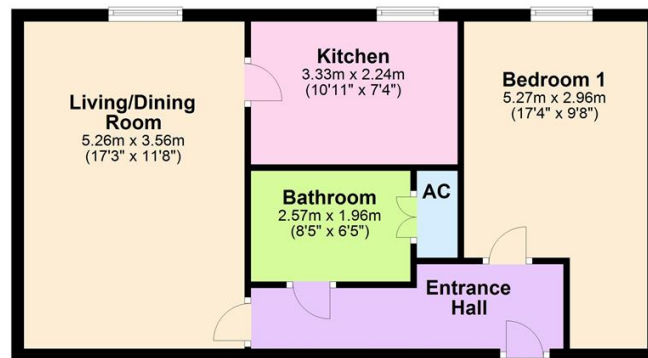

Total area: approx. 53.1 sq. metres (571.5 sq. feet)



15-16 Market Place, Kettering, Northamptonshire, NN16 0AJ